

COORDENADAS UTM
DATUM SIRGAS 2000
FUSO 23, MC-45°

Roteiro do Perímetro do terreno
Área: 2.314,86 m²
Perímetro: 217,98

De	Para	Ângulo Interno	Azimute	Distancia (m)	Coord. Norte(Y)	Coord. Este(X)	Latitude	Longitude
V-01	V-02	272º, 09' 48"	265º, 37' 28"	59,84	375399,291	7772736,365	W046° 11' 31.68"	S020° 08' 18.91"
V-02	V-03	223º, 03' 48"	357º, 47' 16"	76,52	375394,726	7772676,704	W046° 11' 31.85"	S020° 08' 20.85"
V-03	V-04	227º, 44' 37"	40º, 51' 04"	2,24	375471,1898	7772673,75	W046° 11' 29.22"	S020° 08' 20.96"
V-04	V-05	207º, 59' 42"	88º, 35' 42"	57,01	375472,8865	7772675,218	W046° 11' 29.16"	S020° 08' 20.91"
V-05	V-06	215º, 47' 19"	116º, 35' 24"	1,13	375474,2844	7772732,209	W046° 11' 29.10"	S020° 08' 19.06"
V-06	V-07	205º, 38' 02"	152º, 22' 43"	1,30	375473,779	7772733,218	W046° 11' 29.11"	S020° 08' 19.03"
V-07	V-01	267º, 36' 43"	178º, 00' 45"	73,38	375472,6291	7772733,82	W046° 11' 29.15"	S020° 08' 19.01"

NOTAS GERAIS

- PROJETO GEOMÉTRICO EM PLANTA SOBRE LEVANTAMENTO TOPOGRÁFICO PLANIALTIMÉTRICO DE CAMPO COM CURVAS DE NÍVEL 1/1 METRO.
- COORDENADAS TOPOGRÁFICAS GEOREFERENCIADAS DATUM SIRGAS2000, FUSO 24, MC-39°.
- INSTRUMENTO UTILIZADO NO LEVANTAMENTO:
 - RECEPTOR GPS GNSS L1L2 TOPOMAP T10 RTK INTEGRADO, PRECISÃO HORIZONTAL DE: 8 MM + 1 PPM RMS E VERTICAL DE: 15 MM + 1 PPM RMS
 - ESTAÇÃO TOTAL MODELO GPT-3007N PRECISÃO LINEAR DE 3 MM + 2PPM LEITURA DIRETA DE 1 SEGUNDO E PRECISÃO DE 7"
- QUADRO DE ROTEIRO DO PERÍMETRO, COORDENADAS DO VÉRTICES REFERENTES AS DA COLUNA "DE".
- QUADRO DE RESUMO DE ÁREAS DO LEVANTAMENTO.

Quadro de Resumo Levantamento	
Quantitativo	m ²
Área do Terreno	4.590,85
Área Excedente ao Terreno	3.122,17
Área Total da Levantamento	7.713,02

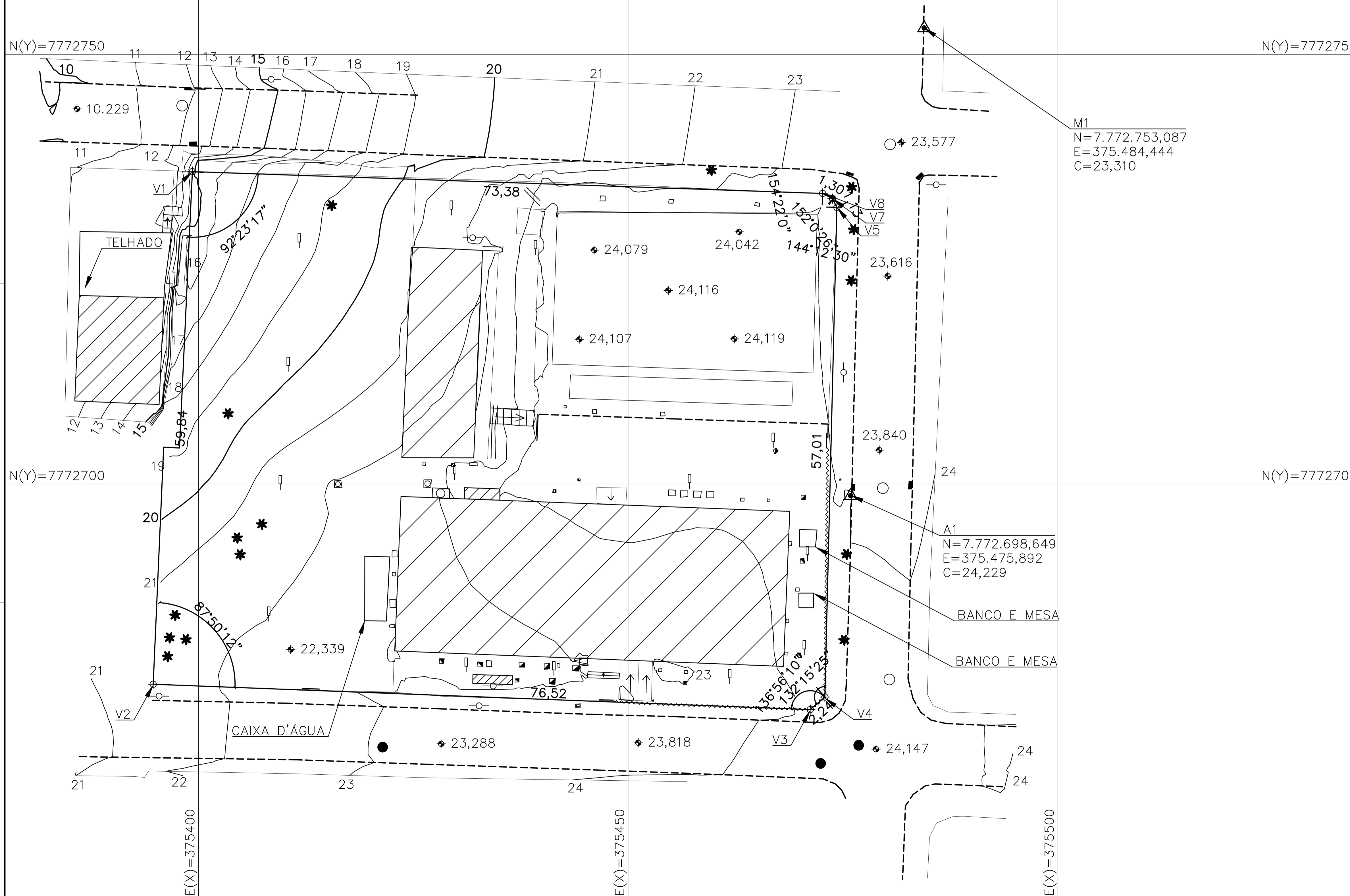

LEGENDA

- * ÁRVORE
- MURO EXISTENTE
- - - - MEIO FIO EXISTENTE
- POSTE
- ~ CURVAS DE NÍVEL
- ◆ NÍVEL
- PORTÃO
- CAIXA
- ⊕ VERTICES
- PVE
- ▨ EDIFICAÇÃO
- BOCA DE LOBO EXISTENTE
- PVA
- LUMINÁRIA

01	EMISSÃO INICIAL	MAYCON	DEZ. 2019
Nº.	DESCRIÇÃO	RES.P.	DATA

REVISÃO

GOVERNO DO ESTADO DO ESPÍRITO SANTO

SECRETARIA DE ESTADO DA EDUCAÇÃO - SEDU

GERÊNCIA DE REDE FÍSICA ESCOLAR

TÍTULO: EEEFM JACARAÍPE			
ENDEREÇO: RUA GUACYRA, 713 - JARDIM ATLÂNTICO, SERRA - ES			
PRANCHA: TOPOGRAFIA	PROJETO: TOPOGRAFIA		
SECRETÁRIO ESTADUAL: VITOR AMORIM DE ANGELO	ESCALA: 1:250	UNIDADE: METROS	
GERENTE DA GERFE: MARCELO ANDRIM GONÇALVES	CREA-MG: 64866/D	VISTO:	
COORDENADOR GERAL: EDSON DE OLIVEIRA PIRES	CREA-MG: 94.896/D	VISTO:	
AUTOR PROJETO: MATHEUS COMANDUCCI FERNANDES NETO	CAU-ES:	VISTO:	
CO-AUTOR PROJETO:	CREA-MG: 94.896/D	VISTO:	
RESPONSÁVEL TÉCNICO: MATHEUS COMANDUCCI FERNANDES NETO	DESENHO: DIEGO	VISTO:	
ARQUIVO: PRJ-PRI-TOP-0101-SEDU-EEEF_JACARAÍPE-REV01.dwg			
REFERÊNCIA: LEVANTAMENTO TOPOGRÁFICO PLANIALTIMÉTRICO CADASTRAL	ÁREAS: ÁREA DO TERRENO: 4.590,85m ² ÁREA EXISTENTE: 00,00m ² ÁREA DE REFORMA: 00,00m ² ÁREA DE AMPLIAÇÃO: 00,00m ² ÁREA DE CONSTRUÇÃO: 1.043,16m ²	FOLHA: 01 01	
FORMATO: A1	OBSERVAÇÕES:	DATA: 16/12/2019	REVISÃO: R-00

Estação	Descrição	HI	Norte	Este	Cota	Azimute
M1	E	1,392				

Tipo	Nome	Descrição	AHD	AVD	HS	DI	DH	EC	DHxC
Ré	A1		0°00'01"	89°01'38"	1,560		55,1050		
Auxiliar	B1	A	0°55'51"	89°10'50"	1,560		55,5510		
Irradiado	1	ARVORE	358°31'25"	89°11'19"	1,560		71,8390		
Irradiado	2	ARVORE	359°28'05"	89°01'52"	1,560		61,9110		
Irradiado	3	POSTE	4°12'45"	88°56'37"	1,560		41,1670		
Irradiado	4	ARVORE	7°10'07"	88°41'36"	1,560		30,6080		
Irradiado	5	ARVORE	10°23'13"	88°41'43"	1,560		24,8410		
Irradiado	6	ARVORE	15°33'14"	88°35'52"	1,560		20,3500		
Irradiado	7	MURO	17°01'13"	88°59'40"	1,560		23,2190		
Irradiado	8	MURO	19°17'53"	89°03'18"	1,560		22,5500		
Irradiado	9	MURO	22°35'24"	89°10'50"	1,560		22,6010		
Irradiado	10	MF	13°08'56"	88°57'17"	1,560		20,1340		
Irradiado	11	MF	14°57'13"	88°59'59"	1,560		19,2970		
Irradiado	12	MF	16°53'31"	88°58'54"	1,560		19,2730		
Irradiado	13	MF	20°08'12"	89°11'08"	1,560		19,4140		
Irradiado	14	MF	29°44'43"	89°35'26"	1,560		21,0830		
Irradiado	15	BL	16°51'34"	89°10'35"	1,560		18,8600		
Irradiado	16	BL	19°18'05"	89°15'15"	1,560		18,9740		
Irradiado	17	BL	19°10'09"	89°15'14"	1,560		19,2410		
Irradiado	18	BL	18°00'28"	89°15'10"	1,560		19,0720		
Irradiado	19	ASSOR	18°00'15"	89°12'35"	1,560		19,0710		
Irradiado	20	PVE	13°05'54"	89°02'42"	1,560		17,9540		
Irradiado	21	MURO	43°57'43"	88°34'40"	1,560		12,2660		
Auxiliar	L1	A	30°25'08"	89°21'11"	1,560		21,4840		
Irradiado	22	MURO	342°59'12"	88°10'48"	1,560		19,9060		
Irradiado	23	POSTE	346°42'04"	88°04'45"	1,560		18,3090		
Irradiado	24	MF	340°11'04"	89°15'42"	1,560		17,4770		
Irradiado	25	MF	349°28'38"	89°03'09"	1,560		17,1180		
Irradiado	26	MF	351°35'48"	89°01'39"	1,560		17,3560		
Irradiado	27	MF	352°29'26"	89°01'56"	1,560		17,8140		
Irradiado	28	MF	352°48'00"	89°01'59"	1,560		18,5370		
Irradiado	29	BL	352°03'37"	89°03'58"	1,560		16,9320		
Irradiado	30	BL	353°57'24"	89°01'11"	1,560		17,5360		
Irradiado	31	BL	353°04'56"	89°01'01"	1,560		17,7150		
Irradiado	32	ASSOR	352°54'54"	89°04'53"	1,560		17,3330		

Estação	Descrição	HI	Norte	Este	Cota	Azimute
L1	E	1,380				

Tipo	Nome	Descrição	AHD	AVD	HS	DI	DH	EC	DHxC
Ré	M1		0°00'03"	89°42'29"	1,560		21,4840		
Irradiado	33	ARVORE	230°57'13"	91°36'57"	1,560		11,1400		
Irradiado	34	MURO	219°55'10"	91°09'30"	1,560		11,3990		
Auxiliar	L2	A	240°45'19"	95°48'46"	1,560		51,7980		

Estação	Descrição	HI	Norte	Este	Cota	Azimute
L2	E	1,420				

Tipo	Nome	Descrição	AHD	AVD	HS	DI	DH	EC	DHxC
Ré	L1		0°00'00"	83°49'39"	1,560		51,8050		
Irradiado	35	PE	47°11'09"	78°32'23"	1,560		10,1750		
Irradiado	36	PE	102°21'12"	89°16'25"	1,560		8,7960		
Irradiado	37	PE	139°51'57"	99°35'22"	1,560		14,6110		
Irradiado	38	PE	151°02'08"	103°06'41"	1,560		21,9590		
Irradiado	39	BL	170°37'24"	106°00'07"	1,560		20,6000		
Irradiado	40	BL	170°47'39"	106°02'03"	1,560		21,4820		
Irradiado	41	BL	171°27'37"	105°59'50"	1,560		21,4500		
Irradiado	42	F	171°05'06"	106°01'07"	2,700		21,0190		
Irradiado	43	ASSOR	153°42'05"	104°24'54"	1,560		21,2760		
Irradiado	44	CR	148°07'54"	101°00'53"	0,000		21,3000		
Irradiado	45	CR	121°21'46"	88°27'27"	1,600		10,9170		

Estação	Descrição	HI	Norte	Este	Cota	Azimute
B1	E	1,588				

Tipo	Nome	Descrição	AHD	AVD	HS	DI	DH	EC	DHxC
Ré	M1		0°00'03"	90°40'21"	1,560		55,5400		
Auxiliar	M0	A	154°31'26"	89°46'53"	1,560		34,9190		
Irradiado	46	GRADE	175°11'46"	89°38'54"	1,560		23,2290		
Irradiado	47	GRADE	178°47'30"	89°34'43"	1,560		24,8890		
Irradiado	48	MURO	125°21'34"	89°29'36"	1,560		14,4540		
Irradiado	49	CX-ESG	345°56'11"	90°27'44"	1,560		2,2640		
Irradiado	50	CX-ESG	346°26'18"	90°27'40"	1,560		2,1150		
Irradiado	51	CX-ESG	341°37'55"	90°27'40"	1,560		2,1120		
Irradiado	52	EDIF	246°09'28"	88°44'54"	1,560		6,3180		
Irradiado	53	EDIF	189°27'11"	89°34'05"	1,560		20,7400		
Irradiado	54	CX-ENE	184°28'19"	89°31'18"	1,560		19,1350		
Irradiado	55	CX-ENE	185°16'00"	89°31'20"	1,560		18,6650		
Irradiado	56	CX-ENE	186°21'14"	89°31'24"	1,560		18,7540		
Irradiado	57	CX-ENE	200°21'21"	89°00'34"	1,560		8,7390		
Irradiado	58	CX-ENE	202°45'03"	89°03'51"	1,560		8,3050		
Irradiado	59	CX-ENE	204°51'51"	89°03'57"	1,560		8,5850		
Irradiado	60	CX-ENE	258°20'07"	88°27'02"	1,560		4,8050		
Irradiado	61	CX-ENE	258°16'01"	88°26'29"	1,560		4,3210		
Irradiado	62	CX-ENE	264°40'45"	88°15'27"	1,560		4,3050		
Irradiado	63	CX-ENE	293°20'15"	89°18'02"	1,560		9,3940		
Irradiado	64	CX-ENE	296°24'15"	89°18'07"	1,560		9,2670		
Irradiado	65	CX-ENE	297°12'17"	89°18'01"	1,560		9,6930		
Irradiado	66	CX-ESG	263°09'33"	89°36'16"	1,560		15,8180		
Irradiado	67	CX-ESG	263°04'12"	89°35'52"	1,560		14,9720		
Irradiado	68	CX-ESG	260°19'29"	89°32'49"	1,560		14,9670		
Irradiado	69	CX-ESG	263°00'16"	89°33'45"	1,560		16,4320		
Irradiado	70	CX-ESG	260°20'34"	89°30'03"	1,560		16,5080		
Irradiado	71	CX-ESG	260°18'41"	89°30'50"	1,560		17,3040		
Irradiado	72	CX-ESG	262°53'24"	89°34'28"	1,560		18,0100		
Irradiado	73	CX-ESG	260°48'51"	89°33'19"	1,560		17,9760		
Irradiado	74	CX-ESG	260°28'44"	89°35'45"	1,560		18,8360		

Estação	Descrição	HI	Norte	Este	Cota	Azimute
B1	E	1,588				

Tipo	Nome	Descrição	AHD	AVD	HS	DI	DH	EC	DHxC
Irradiado	75	CX-ESG	260°57'32"	89°34'42"	1,560		19,3910		
Irradiado	76	CX-ESG	262°54'03"	89°35'42"	1,560		19,4260		
Irradiado	77	CX-ESG	262°54'04"	89°35'45"	1,560		20,2480		
Irradiado	78	LUM	263°42'32"	89°35'55"	1,560		17,8300		
Irradiado	79	LUM	296°24'59"	89°17'09"	1,560		9,9810		
Irradiado	80	CX-LAC	260°10'49"	89°23'03"	1,560		11,8630		
Irradiado	81	CX-LAC	260°14'15"	89°17'20"	1,560		11,4260		
Irradiado	82	CX-LAC	258°23'33"	89°16'42"	1,560		11,4540		
Irradiado	83	CX-LAC	259°44'28"	89°06'32"	1,560		8,7400		
Irradiado	84	CX-LAC	259°09'44"	89°06'20"	1,560		8,4240		
Irradiado	85	CX-LAC	257°03'23"	89°06'34"	1,560		8,4320		
Irradiado	86	CX-DREN	219°26'16"	88°57'20"	1,560		7,7590		
Irradiado	87	CX-DREN	217°13'09"	88°55'16"	1,560		8,0770		
Irradiado	88	CX-DREN	219°08'54"	88°55'22"	1,560		8,3180		
Irradiado	89	CX-DREN	194°40'51"	89°28'27"	1,560		15,8780		
Irradiado	90	CX-DREN	195°00'06"	89°28'49"	1,560		15,5000		
Irradiado	91	CX-DREN	194°03'19"	89°26'38"	1,560		15,3960		
Irradiado	92	CX-DREN	189°20'10"	89°34'04"	1,560		19,3230		
Irradiado	93	CX-DREN	189°34'27"	89°32'09"	1,560		19,0300		
Irradiado	94	CX-DREN	190°45'12"	89°31'06"	1,560		19,1180		
Auxiliar	C1	A	178°47'14"	89°29'35"	1,560		20,8340		
Irradiado	95	LUM	183°48'43"	89°28'09"	1,560		18,7740		
Irradiado	96	LUM	199°23'58"	88°58'15"	1,560		8,3310		
Irradiado	97	CX-LAC	196°59'28"	89°16'49"	1,560		12,1230		
Irradiado	98	CX-LAC	197°36'51"	89°16'52"	1,560		11,7410		
Irradiado	99	CX-LAC	195°51'14"	89°10'12"	1,560		11,5880		
Irradiado	100	BANCO-MESA	190°49'42"	89°16'39"	1,560		13,2250		
Irradiado	101	BANCO-MESA	191°47'06"	89°16'58"	1,560		13,7200		
Irradiado	102	BANCO-MESA	194°47'43"	89°12'37"	1,560		12,1480		
Irradiado	103	BANCO-MESA	186°59'16"	89°06'01"	1,560		11,5400		
Irradiado	104	BANCO-MESA	199°02'07"	88°26'47"	1,560		6,4770		
Irradiado	105	BANCO-MESA	208°45'02"	87°58'09"	1,560		4,7380		
Irradiado	106	BANCO-MESA	223°54'42"	88°44'28"	1,560		6,1560		
Irradiado	107	PAV-BLOQ	273°43'41"	89°26'47"	1,560		15,7420		
Irradiado	108	MF	339°06'29"	89°45'04"	1,560		8,7940		
Irradiado	109	PORTAO	339°11'48"	89°44'01"	1,560		8,7650		
Irradiado	110	PORTAO	333°45'16"	89°31'52"	1,560		6,0990		
Irradiado	111	QUADRA	336°56'29"	89°27'09"	1,560		14,9730		
Irradiado	112	TELHADO	330°52'22"	89°15'41"	1,560		9,9160		
Irradiado	113	ARQ	321°29'23"	89°20'59"	1,560		12,2520		
Irradiado	114	ARQ	327°07'53"	89°30'22"	1,560		14,6970		
Irradiado	115	ARQ	280°13'44"	89°47'35"	1,560		33,8340		
Irradiado	116	ARQ	284°32'44"	89°07'06"	2,000		34,7510		
Irradiado	117	TEL	278°17'38"	89°48'15"	1,560		35,4910		
Irradiado	118	CX-LAC	278°07'34"	89°48'05"	1,560		34,0620		
Irradiado	119	CX-LAC	278°15'18"	89°48'02"	1,560		33,8120		
Irradiado	120	CX-LAC	278°41'12"	89°48'02"	1,560		33,8890		
Irradiado	121	CX-LAC	278°52'10"	89°46'37"	1,560		30,7260		

Estação	Descrição	HI	Norte	Este	Cota	Azimute
B1	E	1,588				

Tipo	Nome	Descrição	AHD	AVD	HS	DI	DH	EC	DHxC
Irradiado	122	CX-LAC	279°03'45"	89°46'42"	1,560		30,2560		
Irradiado	123	CX-LAC	279°57'28"	89°46'39"	1,560		30,4050		
Irradiado	124	MF	275°37'56"	89°53'41"	1,560		36,5640		
Irradiado	125	CANALETA	275°27'21"	89°53'14"	1,560		36,7770		
Irradiado	126	GRELHA	270°47'54"	89°53'14"	1,560		36,1630		
Irradiado	127	GRELHA	275°28'24"	89°53'13"	1,560		36,6900		
Irradiado	128	GRELHA	275°30'27"	89°53'13"	1,560		36,8280		
Irradiado	129	GRELHA	271°02'02"	89°54'10"	1,560		36,3140		
Irradiado	130	ESCADA	273°16'04"	89°49'39"	1,560		36,9280		
Irradiado	131	ESCADA	276°00'54"	89°48'37"	1,560		37,2620		
Auxiliar	B1A	A	277°22'44"	89°48'04"	1,560		33,7200		
Auxiliar	B2	A	263°19'11"	89°53'11"	1,560		39,0890		
Irradiado	132	RAMPA	268°50'31"	89°43'25"	1,560		26,1400		
Irradiado	133	RAMPA	273°11'20"	89°45'03"	1,560		26,4460		
Irradiado	134	SOLEIRA	258°23'33"	89°21'03"	1,560		27,5810		
Irradiado	135	RAMPA	269°01'46"	89°45'58"	0,100		41,4870		
Irradiado	136	MF	163°44'42"	89°24'19"	1,560		7,9390		
Irradiado	137	MF	117°17'03"	90°02'24"	1,560		9,9900		

Estação	Descrição	HI	Norte	Este	Cota	Azimute
B1A	E	1,547				

Tipo	Nome	Descrição	AHD	AVD	HS	DI	DH	EC	DHxC
Ré	B1		0°00'01"	90°13'44"	1,560		33,7210		
Irradiado	138	ESCADA	146°51'22"	100°02'49"	1,560		5,6200		
Irradiado	139	ESCADA	166°00'24"	96°11'05"	2,000		5,4260		
Irradiado	140	ESCADA	152°03'19"	94°40'57"	2,000		7,3160		
Irradiado	141	ESCADA	166°02'46"	94°49'36"	2,000		7,2390		
Irradiado	142	ESCADA	166°11'40"	96°38'26"	2,600		8,7040		
Irradiado	143	ESCADA	154°03'51"	96°34'56"	2,600		8,8280		
Irradiado	144	MURO	119°19'00"	90°14'07"	1,560		5,1470		
Irradiado	145	MURO	137°24'34"	90°14'23"	1,560		4,0550		
Irradiado	146	MURO	153°48'20"	103°01'10"	1,560		8,7800		
Irradiado	147	MURO	166°06'35"	96°38'20"	2,600		8,6700		
Irradiado	148	TN	18°47'49"	103°00'28"	0,000		6,5830		
Irradiado	149	MF	346°11'28"	89°49'54"	1,560		12,7360		
Irradiado	150	CX-LAC	342°43'15"	89°55'42"	1,560		11,5210		
Irradiado	151	CX-LAC	344°56'21"	89°51'14"	1,560		11,0450		
Irradiado	152	CX-LAC	344°44'58"	89°51'24"	1,560		11,5860		
Irradiado	153	CX-LAC	344°48'56"	89°31'51"	1,560		3,0970		
Irradiado	154	CX-LAC	336°25'45"	89°39'09"	1,560		3,1660		
Irradiado	155	CX-LAC	338°00'17"	89°45'33"	1,560		3,6740		
Irradiado	156	QUADRA	237°06'06"	89°50'01"	1,560		5,8270		
Irradiado	157	N	259°06'47"	95°34'00"	0,000		15,2020		
Irradiado	158	BASE	223°23'07"	86°35'31"	1,560		3,9180		
Irradiado	159	BASE	198°13'20"	87°39'46"	1,560		5,7100		
Irradiado	160	BASE	171°24'09"	86°34'33"	1,560		4,6500		
Irradiado	161	BASE	182°43'02"	82°43'59"	1,560		2,0560		

Estação	Descrição	HI	Norte	Este	Cota	Azimute
B1A	E	1,547				

Tipo	Nome	Descrição	AHD	AVD	HS	DI	DH	EC	DHxC
Irradiado	162	BASE-PE	181°58'08"	89°22'36"	1,560		1,9440		
Irradiado	163	BASE-PE	224°08'13"	89°47'50"	1,560		3,8950		
Irradiado	164	BASE-PE	198°26'04"	94°02'20"	1,560		5,7850		
Irradiado	165	BASE-PE	169°55'13"	97°33'41"	1,560		4,7060		
Irradiado	166	BASE-PE	172°21'50"	94°12'57"	1,560		3,7730		
Irradiado	167	BASE-PE	171°50'05"	89°48'02"	1,560		3,7200		
Irradiado	168	PASSEIO	233°43'24"	90°15'03"	1,560		10,6240		
Irradiado	169	QUADRA	304°32'15"	88°29'53"	2,600		37,2640		
Irradiado	170	MURO	304°06'30"	88°35'20"	2,600		39,5480		
Irradiado	171	MURO	305°47'11"	88°34'37"	2,600		39,1610		
Irradiado	172	MURO	302°06'25"	88°34'48"	2,600		38,7300		
Irradiado	173	CX-LAC	295°09'34"	88°22'05"	2,600		32,6080		
Irradiado	174	CX-LAC	294°51'16"	88°24'05"	2,600		32,9360		
Irradiado	175	CX-LAC	295°34'12"	88°24'04"	2,600		33,1980		
Irradiado	176	MURO	284°44'48"	88°16'14"	2,600		30,3250		
Irradiado	177	CX-LAC	279°38'32"	88°08'36"	2,600		27,7690		
Irradiado	178	CX-LAC	279°57'46"	88°05'49"	2,600		27,3600		
Irradiado	179	CX-LAC	278°58'01"	88°04'15"	2,600		27,1390		
Auxiliar	B1B	A	240°22'24"	89°40'05"	1,560		21,7540		
Irradiado	180	TN	146°07'27"	95°36'59"	1,560		6,2660		
Irradiado	181	TN	133°16'50"	88°14'59"	2,400		6,9630		
Irradiado	182	TN	151°26'50"	96°16'46"	2,400		8,2590		
Irradiado	183	CANALETA	151°32'03"	95°17'00"	2,400		8,7560		
Irradiado	184	CANALETA	151°29'19"	96°38'08"	2,400		8,4050		
Irradiado	185	CANALETA	151°02'17"	98°05'02"	2,400		8,5960		

Estação	Descrição	HI	Norte	Este	Cota	Azimute
B1B	E	1,550				

Tipo	Nome	Descrição	AHD	AVD	HS	DI	DH	EC	DHxC
Ré	B1A		359°59'58"	90°15'32"	1,560		21,7390		
Irradiado	186	EDIF	25°10'51"	94°28'53"	1,560		27,2130		
Irradiado	187	CANALETA	22°39'36"	90°19'42"	3,600		20,7870		
Irradiado	188	CANALETA	21°21'16"	89°48'32"	3,600		20,6960		
Irradiado	189	SOLEIRA	41°04'52"	100°34'36"	1,560		11,2380		
Irradiado	190	EDIF	76°45'47"	113°07'03"	1,560		5,5460		
Irradiado	191	CANALETA	64°16'03"	121°58'52"	1,560		3,2500		
Irradiado	192	CANALETA	62°36'14"	120°28'01"	1,560		3,8780		
Irradiado	193	CANALETA	62°36'15"	122°28'55"	1,560		3,7060		
Irradiado	194	TN	25°44'55"	99°39'18"	1,560		10,7820		
Irradiado	195	PASSEIO	60°16'56"	116°32'55"	1,560		4,2560		
Irradiado	196	PASSEIO	27°54'05"	98°47'41"	1,560		13,7130		
Irradiado	197	PASSEIO	9°05'47"	90°26'51"	1,560		17,8020		
Irradiado	198	TN	9°13'52"	90°52'17"	1,560		17,7950		
Irradiado	199	PASSEIO	4°43'04"	90°57'18"	1,560		9,3730		
Irradiado	200	PASSEIO	306°21'07"	97°33'26"	1,560		1,7520		
Irradiado	201	LUM	350°50'07"	94°47'11"	1,560		3,1210		
Irradiado	202	PASSEIO	227°54'53"	95°14'29"	1,560		2,9210		

Estação	Descrição	HI	Norte	Este	Cota	Azimute
B1B	E	1,550				

Tipo	Nome	Descrição	AHD	AVD	HS	DI	DH	EC	DHxC
Irradiado	203	PASSEIO	213°10'53"	93°06'40"	1,560		5,5330		
Irradiado	204	MURO	213°10'53"	93°06'36"	1,560		5,5300		
Irradiado	205	MURO	211°00'14"	101°50'07"	1,560		5,4660		
Irradiado	206	PE	211°07'59"	101°50'09"	1,560		5,4690		
Irradiado	207	PE	226°38'08"	107°02'38"	1,560		2,9090		
Irradiado	208	PE	171°50'56"	118°03'56"	1,560		2,7720		
Irradiado	209	PE	76°18'33"	102°45'34"	2,600		1,2400		
Irradiado	210	PE	306°49'29"	105°45'15"	1,560		1,6510		
Irradiado	211	BASE	300°24'01"	89°11'48"	1,560		2,0070		
Irradiado	212	BASE	79°10'03"	89°42'38"	1,560		1,1710		
Irradiado	213	BASE	172°55'13"	89°48'10"	1,560		2,7280		
Irradiado	214	BASE	233°52'25"	89°34'31"	1,560		3,0750		
Irradiado	215	CX-LAC	262°28'12"	91°20'02"	1,560		9,8620		
Irradiado	216	CX-LAC	259°23'51"	91°19'27"	1,560		10,0670		
Irradiado	217	CX-LAC	258°00'33"	91°25'46"	1,560		9,5610		
Irradiado	218	QUADRA	252°02'36"	92°31'23"	1,560		4,2850		
Irradiado	219	CANALETA	218°53'44"	102°05'26"	1,560		3,7920		
Irradiado	220	CANALETA	223°00'03"	102°09'42"	1,560		3,2380		
Irradiado	221	CANALETA	219°04'11"	104°25'09"	1,560		3,5740		
Irradiado	222	CANALETA	190°25'09"	111°22'38"	1,560		4,6650		
Irradiado	223	CANALETA	193°51'24"	110°14'58"	1,560		4,9300		
Irradiado	224	CANALETA	193°21'50"	112°05'44"	1,560		4,7220		
Irradiado	225	MURO	150°43'28"	107°13'02"	1,560		7,1640		
Irradiado	226	MURO	125°55'54"	103°54'07"	1,560		13,9370		
Irradiado	227	MURO	94°44'43"	103°34'01"	1,560		13,2380		
Irradiado	228	EDIF-030CM	94°44'41"	103°33'47"	1,560		13,2410		
Irradiado	229	LUM	113°33'37"	105°46'06"	1,560		8,8040		
Irradiado	230	POST-VAZIO	93°52'22"	107°22'57"	1,560		6,2280		
Irradiado	231	CANALETA	81°01'15"	113°12'52"	1,560		5,3450		
Irradiado	232	CANALETA	77°14'37"	113°04'38"	1,560		5,5990		
Irradiado	233	TN	87°08'40"	106°53'52"	1,560		8,4470		
Irradiado	234	EDIF	92°03'27"	104°56'07"	1,560		11,6700		

Estação	Descrição	HI	Norte	Este	Cota	Azimute
B2	E	1,520				

Tipo	Nome	Descrição	AHD	AVD	HS	DI	DH	EC	DHxC
Ré	B1		0°00'00"	90°06'11"	1,560		39,1040		
Irradiado	235	RAMPA	11°38'37"	88°33'45"	1,560		10,8210		
Irradiado	236	RAMPA	8°59'31"	88°50'07"	1,560		14,1520		
Irradiado	237	RAMPA	0°18'37"	89°33'56"	1,560		13,9780		
Irradiado	238	RAMPA	1°55'08"	89°34'10"	1,560		10,4730		
Irradiado	239	CX-ESG	8°24'39"	89°23'29"	1,560		5,8330		
Irradiado	240	CX-ESG	9°01'43"	89°13'02"	1,560		5,4790		
Irradiado	241	CX-ESG	12°40'30"	89°13'19"	1,560		5,5280		
Irradiado	242	TN	5°01'53"	89°48'44"	1,560		24,0620		
Irradiado	243	CX-ENE	357°55'59"	89°32'46"	1,560		8,5070		
Irradiado	244	CX-ENE	357°49'43"	89°32'45"	1,560		8,2480		

Estação	Descrição	HI	Norte	Este	Cota	Azimute
B2	E	1,520				

Tipo	Nome	Descrição	AHD	AVD	HS	DI	DH	EC	DHxC
Irradiado	245	CX-ENE	356°07'08"	89°32'50"	1,560		8,2340		
Irradiado	246	TN	307°31'09"	88°31'33"	1,560		2,8320		
Irradiado	247	TN	282°43'23"	107°55'26"	1,400		2,3980		
Irradiado	248	CANALETA	237°19'40"	103°28'34"	2,600		2,7610		
Irradiado	249	CANALETA	229°49'23"	104°43'15"	2,600		3,1100		
Irradiado	250	CANALETA	232°45'07"	106°24'23"	2,600		3,1090		
Irradiado	251	PASSEIO	223°36'44"	106°08'22"	2,600		3,3060		
Irradiado	252	RAMPA	229°14'42"	62°28'25"	1,560		3,1390		
Irradiado	253	RAMPA	153°15'00"	91°32'43"	1,560		0,8970		
Irradiado	254	RAMPA	248°27'58"	89°54'15"	1,560		2,2030		
Irradiado	255	CS-GAS	103°48'06"	90°10'23"	1,560		2,6130		
Irradiado	256	CS-GAS	124°23'06"	89°44'56"	1,560		1,3720		
Irradiado	257	TN	134°32'21"	101°16'36"	1,560		1,5010		
Irradiado	258	TN	151°22'48"	104°52'06"	1,560		1,1110		
Irradiado	259	CS-GAS	166°06'10"	95°59'12"	1,560		5,0430		
Irradiado	260	CS-GAS	152°32'39"	86°55'46"	2,600		5,5410		
Irradiado	261	CX-ESG	158°19'48"	88°12'55"	2,600		7,0630		
Irradiado	262	CX-ESG	167°46'26"	89°26'55"	2,600		6,7700		
Irradiado	263	CX-ESG	170°44'21"	91°28'30"	2,600		8,7570		
Irradiado	264	CX-ESG	163°28'32"	86°56'43"	3,600		8,9570		
Irradiado	265	CX-ESG	176°43'58"	98°03'02"	1,560		8,8100		
Irradiado	266	CX-ESG	171°03'10"	97°59'12"	1,560		8,9170		
Irradiado	267	CX-ESG	170°29'22"	97°56'21"	1,560		8,7240		
Irradiado	268	CX-ESG	171°11'29"	98°01'13"	1,560		9,7300		
Irradiado	269	CX-LAC	186°11'37"	98°18'44"	1,560		9,9320		
Irradiado	270	CX-LAC	186°33'23"	98°23'21"	1,560		9,6320		
Irradiado	271	CX-LAC	189°00'57"	98°20'20"	1,560		9,6420		
Irradiado	272	CX-LAC	190°04'58"	97°53'08"	1,560		6,6280		
Irradiado	273	CX-LAC	190°31'09"	97°48'43"	1,560		6,2750		
Irradiado	274	CX-LAC	193°56'43"	97°46'09"	1,560		6,3750		
Irradiado	275	CX-LAC	197°37'07"	97°29'05"	1,560		4,6380		
Irradiado	276	CX-LAC	201°43'22"	96°58'20"	1,560		3,8250		
Irradiado	277	CX-LAC	206°26'04"	96°48'35"	1,560		3,9880		
Irradiado	278	LUM	176°29'00"	97°40'15"	1,560		6,0960		
Auxiliar	B3	A	173°35'29"	95°54'41"	1,560		16,8250		

Estação	Descrição	HI	Norte	Este	Cota	Azimute
B3	E	1,510				

Tipo	Nome	Descrição	AHD	AVD	HS	DI	DH	EC	DHxC
Ré	B2		0°00'05"	83°47'26"	1,560		16,8370		
Irradiado	279	EDIF	15°58'50"	89°07'33"	1,560		4,5690		
Irradiado	280	EDIF-RAMPA	325°42'46"	90°47'53"	1,560		5,7470		
Irradiado	281	CX-AGUA	71°45'59"	86°33'56"	1,560		8,6360		
Irradiado	282	CX-AGUA-BA	83°10'09"	81°25'07"	3,600		15,7530		
Irradiado	283	CX-AGUA-BA	92°22'43"	81°05'30"	3,600		15,4850		
Irradiado	284	EDIF	82°08'33"	81°30'20"	3,600		19,3600		
Irradiado	285	PASSEIO	85°01'33"	81°35'20"	3,600		19,0300		

Estação	Descrição	HI	Norte	Este	Cota	Azimute
B3	E	1,510				

Tipo	Nome	Descrição	AHD	AVD	HS	DI	DH	EC	DHxC
Irradiado	286	CX-LAC	80°05'32"	80°23'08"	3,600		16,3710		
Irradiado	287	CX-LAC	81°53'55"	80°17'34"	3,600		16,1930		
Irradiado	288	CX-LAC	82°25'38"	80°24'12"	3,600		16,5090		
Irradiado	289	CX-LAC	80°22'08"	79°13'31"	3,600		14,2740		
Irradiado	290	CX-LAC	79°37'52"	78°47'16"	3,600		13,3800		
Irradiado	291	CX-LAC	76°41'42"	78°56'33"	3,600		13,5810		
Irradiado	292	CX-LAC	73°57'14"	76°20'15"	3,600		10,3870		
Irradiado	293	CX-LAC	73°57'46"	86°57'05"	1,560		10,4320		
Irradiado	294	CX-LAC	74°42'08"	86°59'50"	1,560		10,8180		
Irradiado	295	CX-LAC	72°56'56"	87°03'13"	1,560		10,9440		
Irradiado	296	CX-LAC	70°18'23"	86°31'35"	1,560		8,7480		
Irradiado	297	CX-LAC	67°56'15"	86°40'01"	1,560		8,0340		
Irradiado	298	CX-LAC	64°03'09"	86°43'34"	1,560		8,4420		
Irradiado	299	CS-BOMBA	79°17'28"	88°23'45"	1,560		8,2370		
Irradiado	300	CS-BOMBA	89°44'37"	88°47'16"	1,560		7,9630		
Irradiado	301	CS-BOMBA	90°36'46"	87°35'03"	1,560		9,0130		
Irradiado	302	LUM	128°23'37"	90°35'25"	1,560		19,0050		
Irradiado	303	ARVORE	142°34'01"	90°52'13"	1,560		27,1100		
Irradiado	304	ARVORE	142°23'48"	90°45'35"	1,560		30,0250		
Irradiado	305	ARVORE	145°25'53"	90°55'18"	1,560		28,4640		
Irradiado	306	ARVORE	149°01'07"	91°14'23"	1,560		26,4020		
Irradiado	307	MURO	160°19'15"	92°58'08"	1,560		25,6800		
Irradiado	308	ARVORE	154°38'16"	92°01'08"	1,560		16,2410		
Irradiado	309	ARVORE	163°26'18"	93°23'56"	1,560		12,4790		
Irradiado	310	ARVORE	161°27'52"	92°55'15"	1,560		15,7240		
Irradiado	311	LUM	181°47'54"	86°28'10"	2,600		9,5960		
Irradiado	312	TN	116°20'35"	96°47'56"	0,000		13,4400		
Irradiado	313	TN	124°16'53"	111°56'40"	0,000		4,1690		
Irradiado	314	PASSEIO	19°24'50"	89°26'02"	1,560		3,4650		
Irradiado	315	CX-ESG	202°00'10"	93°56'49"	1,560		2,6810		
Irradiado	316	CX-ESG	196°57'10"	93°05'20"	1,560		3,3990		
Irradiado	317	CX-ESG	184°01'14"	91°25'28"	1,560		2,4100		
Auxiliar	B4	A	153°53'45"	91°57'34"	1,560		15,0940		

Estação	Descrição	HI	Norte	Este	Cota	Azimute
B4	E	1,483				

Tipo	Nome	Descrição	AHD	AVD	HS	DI	DH	EC	DHxC
Ré	B3		0°00'02"	87°36'12"	1,560		15,0840		
Irradiado	318	MURO	64°02'45"	85°51'28"	1,560		20,4660		
Irradiado	319	MURO	73°48'42"	81°43'53"	3,600		23,3810		
Irradiado	320	MURO	259°47'04"	96°23'00"	2,600		15,7190		
Irradiado	321	MURO	265°09'17"	96°54'49"	2,600		14,5380		
Irradiado	322	ARVORE	290°26'53"	97°16'10"	1,560		16,2260		
Irradiado	323	LUM	311°26'14"	89°10'35"	3,600		21,3930		
Irradiado	324	LUM	308°38'36"	93°59'09"	2,000		35,7690		
Irradiado	325	MURO	308°05'04"	93°35'46"	2,300		43,9390		
Irradiado	326	MURO	323°10'47"	90°28'25"	2,600		47,0340		

Estação	Descrição	HI	Norte	Este	Cota	Azimute
B4	E	1,483				

Tipo	Nome	Descrição	AHD	AVD	HS	DI	DH	EC	DHxC
Irradiado	327	MURO-ED	327°21'22"	90°08'56"	2,600		40,0410		
Irradiado	328	ARVORE	312°39'04"	89°05'36"	4,600		41,3640		
Irradiado	329	MURO	291°23'48"	96°38'04"	2,500		44,3100		
Irradiado	330	TN	338°50'03"	86°55'51"	3,600		28,5840		

Estação	Descrição	HI	Norte	Este	Cota	Azimute
T1	E	1,514				

Tipo	Nome	Descrição	AHD	AVD	HS	DI	DH	EC	DHxC
Ré	C1		0°00'00"	83°58'39"	3,600		22,3790		
Irradiado	331	LUM	4°01'45"	84°04'20"	2,600		12,4540		
Irradiado	332	CX-ENE	6°53'15"	80°29'52"	2,600		7,1470		
Irradiado	333	CX-ENE	3°54'41"	80°26'25"	2,600		7,0980		
Irradiado	334	CX-ENE	3°50'07"	80°55'42"	2,600		7,4490		
Irradiado	335	CX-LAC	357°03'28"	81°10'30"	2,600		7,5860		
Irradiado	336	CX-LAC	354°21'44"	81°22'55"	2,600		7,5900		
Irradiado	337	CX-LAC	353°49'10"	80°46'43"	2,600		7,1890		
Irradiado	338	CX-LAC	347°37'03"	76°35'48"	2,600		4,6650		
Irradiado	339	CX-LAC	346°36'57"	75°21'51"	2,600		4,2580		
Irradiado	340	CX-LAC	350°56'49"	75°07'11"	2,600		4,1950		
Irradiado	341	RAMPA	97°09'12"	89°17'14"	1,560		2,5220		
Irradiado	342	RAMPA	101°47'42"	88°02'23"	1,560		1,1570		
Irradiado	343	RAMPA	35°06'25"	84°34'01"	1,560		2,1610		
Irradiado	344	TN	34°19'47"	88°22'06"	1,560		2,1040		
Irradiado	345	TN	345°31'30"	88°08'16"	1,560		1,8850		
Irradiado	346	RAMPA	345°31'30"	79°17'48"	1,560		1,9000		
Irradiado	347	RAMPA	57°09'59"	86°15'56"	1,560		3,2480		
Irradiado	348	RAMPA	40°17'22"	87°23'57"	1,560		4,3050		
Irradiado	349	RAMPA	21°17'28"	86°29'04"	1,560		3,6470		
Irradiado	350	RAMPA	353°56'48"	84°30'15"	1,560		3,5170		
Irradiado	351	RAMPA	331°08'28"	84°59'23"	1,560		3,9750		
Irradiado	352	TN	333°37'47"	88°17'12"	1,560		4,1220		
Irradiado	353	TN	38°46'25"	88°04'29"	1,560		4,4600		
Irradiado	354	RAM	313°12'23"	82°46'32"	1,560		2,8390		
Irradiado	355	RAM	261°16'03"	76°10'13"	1,560		2,1730		
Irradiado	356	RAMP	211°55'29"	83°10'23"	1,560		4,4610		
Irradiado	357	TN	210°29'59"	88°40'41"	1,560		4,7150		
Irradiado	358	ESCADA	181°46'53"	88°52'34"	1,560		4,1270		
Irradiado	359	ESCADA-RAM	190°46'19"	82°37'24"	1,560		4,1270		
Irradiado	360	ESCADA-RAM	232°52'21"	87°23'21"	1,070		0,6740		
Irradiado	361	ESCADA-RAM	171°57'50"	84°27'46"	1,560		0,5500		
Irradiado	362	TN	233°31'54"	85°32'11"	1,560		0,6630		
Irradiado	363	POSTE-TRAN	177°09'08"	90°31'29"	1,560		15,1140		
Irradiado	364	EDIF	181°47'17"	90°26'24"	1,560		12,8470		
Irradiado	365	EDIF	177°14'44"	90°26'48"	1,560		12,8950		
Irradiado	366	EDIF	178°38'55"	84°14'36"	3,600		17,4820		
Irradiado	367	LUM	182°47'54"	84°32'02"	3,600		18,2510		
Irradiado	368	LUM	182°17'48"	89°48'53"	1,560		8,0320		

Estação	Descrição	HI	Norte	Este	Cota	Azimute
T1	E	1,514				

Tipo	Nome	Descrição	AHD	AVD	HS	DI	DH	EC	DHxC
Irradiado	369	CX-ENE	188°36'24"	89°12'55"	1,560		5,8930		
Irradiado	370	CX-ENE	189°28'05"	89°02'18"	1,560		5,1710		
Irradiado	371	CX-ENE	197°06'40"	88°56'04"	1,560		5,2390		
Irradiado	372	CX-ENE	191°41'27"	90°18'38"	1,560		8,6940		
Irradiado	373	CX-ENE	187°42'21"	89°52'01"	1,560		8,5870		
Irradiado	374	CX-ENE	186°54'31"	89°54'18"	1,560		9,2090		
Irradiado	375	CX-ENE	176°02'24"	89°53'56"	1,560		8,5990		
Irradiado	376	CX-ENE	175°16'32"	89°41'44"	1,560		7,9400		
Irradiado	377	CX-ENE	180°11'43"	89°47'05"	1,560		7,8550		
Irradiado	378	CX-ENE	186°41'36"	90°19'32"	1,560		12,1290		
Irradiado	379	CX-ENE	186°58'55"	90°16'31"	1,560		11,4970		
Irradiado	380	CX-ENE	189°27'12"	90°18'19"	1,560		11,5540		
Irradiado	381	CX-ENE	185°14'46"	90°46'23"	1,560		16,3590		
Irradiado	382	CX-ENE	187°05'03"	90°44'19"	1,560		16,3930		
Irradiado	383	CX-ENE	186°59'43"	90°44'48"	1,560		17,0060		
Irradiado	384	CX-ENE	186°42'57"	90°57'25"	1,560		21,4390		
Irradiado	385	CX-ENE	186°50'57"	91°00'35"	1,560		20,8950		
Irradiado	386	CX-ENE	185°17'53"	90°53'46"	1,560		20,9590		
Irradiado	387	TN	187°58'05"	91°04'46"	1,560		26,4460		
Irradiado	388	CX-LAC	188°00'45"	90°39'50"	1,560		16,0050		
Irradiado	389	CX-LAC	188°04'05"	90°48'42"	1,560		15,3900		
Irradiado	390	CX-LAC	185°40'06"	90°39'18"	1,560		15,3280		
Irradiado	391	TN	193°19'56"	90°27'50"	1,560		12,9490		
Irradiado	392	CX-ENE	178°24'06"	90°23'38"	1,560		12,1160		
Irradiado	393	CX-ENE	180°15'56"	90°19'34"	1,560		12,0710		
Irradiado	394	CX-ENE	180°12'06"	90°23'31"	1,560		12,5320		
Irradiado	395	CX-DRENO	190°03'28"	89°43'29"	1,560		7,7630		
Irradiado	396	CX-DRENO	190°12'27"	89°37'00"	1,560		7,4110		
Irradiado	397	CX-DRENO	193°17'32"	89°36'50"	1,560		7,5100		
Irradiado	398	CX-LAC	198°01'53"	88°45'55"	1,560		5,2680		
Irradiado	399	CX-LAC	200°40'53"	88°14'22"	1,560		4,3430		
Irradiado	400	CX-LAC	209°58'24"	88°45'28"	1,560		4,7280		
Irradiado	401	PAV-BLOQ	176°55'53"	107°39'03"	0,000		4,6690		

Estação	Descrição	HI	Norte	Este	Cota	Azimute
B1	E	1,465				

Tipo	Nome	Descrição	AHD	AVD	HS	DI	DH	EC	DHxC
Ré	M0		0°00'00"	89°34'37"	1,560		34,9410		
Irradiado	402	PVA	1°02'38"	89°28'06"	1,560		21,7900		
Irradiado	403	PVA	271°35'22"	88°36'44"	1,560		4,8430		
Irradiado	404	BL	277°35'39"	89°24'32"	1,560		7,7500		
Irradiado	405	BL	271°10'55"	89°32'46"	1,560		8,0010		
Irradiado	406	BL	272°10'46"	89°37'39"	1,560		8,3530		
Irradiado	407	ASSOR	272°10'40"	89°37'36"	1,560		8,3300		
Irradiado	408	ASSOR	239°04'01"	88°36'04"	1,560		1,7170		
Irradiado	409	BL	245°23'47"	87°40'33"	1,560		1,4100		
Irradiado	410	BL	228°09'21"	88°26'14"	1,560		1,9810		

Estação	Descrição	HI	Norte	Este	Cota	Azimute
B1	E	1,465				

Tipo	Nome	Descrição	AHD	AVD	HS	DI	DH	EC	DHxC
Irradiado	411	BL	237°36'19"	89°33'08"	1,560		2,1450		
Irradiado	412	PAP-AGUA	169°23'07"	87°48'54"	1,560		4,9540		

Nome	Descrição	Norte	Este	Cota
M1	E	7.772.753,0870	375.484,4440	23,310

Nome	Descrição	Norte	Este	Cota	Azimute	AH	DH	Desnível
B1	A	7.772.698,3563	375.474,9328	23,937	189°51'31"	0°55'50"	55,5510	0,6268
L1	A	7.772.736,4729	375.470,8229	23,385	219°20'48"	30°25'07"	21,4840	0,0746
1	ARVORE	7.772.681,8547	375.475,1277	24,160	187°27'05"	358°31'24"	71,8390	0,8498
2	ARVORE	7.772.691,8395	375.475,4044	24,189	188°23'45"	359°28'04"	61,9110	0,8793
3	POSTE	7.772.712,9979	375.475,0853	23,901	193°08'25"	4°12'44"	41,1670	0,5912
4	ARVORE	7.772.723,6789	375.475,9578	23,840	196°05'47"	7°10'06"	30,6080	0,5302
5	ARVORE	7.772.729,6441	375.476,2277	23,708	199°18'53"	10°23'12"	24,8410	0,3978
6	ARVORE	7.772.734,5666	375.476,0109	23,640	204°28'54"	15°33'13"	20,3500	0,3302
7	MURO	7.772.732,2087	375.474,2844	23,550	205°56'53"	17°01'12"	23,2190	0,2396
8	MURO	7.772.733,2184	375.473,7790	23,514	208°13'33"	19°17'52"	22,5500	0,2040
9	MURO	7.772.733,8201	375.472,6291	23,465	211°31'04"	22°35'23"	22,6010	0,1553
10	MF	7.772.734,4292	375.476,8767	23,509	202°04'36"	13°08'55"	20,1340	0,1994
11	MF	7.772.735,4421	375.476,6317	23,479	203°52'53"	14°57'12"	19,2970	0,1690
12	MF	7.772.735,7380	375.476,0498	23,485	205°49'11"	16°53'30"	19,2730	0,1746
13	MF	7.772.736,1177	375.475,0128	23,418	209°03'52"	20°08'11"	19,4140	0,1080
14	MF	7.772.736,6270	375.471,2698	23,293	218°40'23"	29°44'42"	21,0830	-0,0173
15	BL	7.772.736,1051	375.476,2394	23,413	205°47'14"	16°51'33"	18,8600	0,1032
16	BL	7.772.736,3697	375.475,4693	23,389	208°13'45"	19°18'04"	18,9740	0,0790
17	BL	7.772.736,1135	375.475,3822	23,393	208°05'49"	19°10'08"	19,2410	0,0826
18	BL	7.772.736,0840	375.475,8046	23,391	206°56'08"	18°00'27"	19,0720	0,0808
19	ASSOR	7.772.736,0843	375.475,8062	23,405	206°55'55"	18°00'14"	19,0710	0,0951
20	PVE	7.772.736,4434	375.477,7108	23,441	202°01'34"	13°05'53"	17,9540	0,1313
21	MURO	7.772.745,6863	375.474,6622	23,447	232°53'23"	43°57'42"	12,2660	0,1365
22	MURO	7.772.733,3789	375.487,2438	23,775	171°54'52"	342°59'11"	19,9060	0,4646
23	POSTE	7.772.734,8313	375.485,8395	23,756	175°37'44"	346°42'03"	18,3090	0,4461
24	MF	7.772.735,9246	375.487,7452	23,367	169°06'44"	340°11'03"	17,4770	0,0572
25	MF	7.772.735,9756	375.484,9205	23,425	178°24'18"	349°28'37"	17,1180	0,1151
26	MF	7.772.735,7317	375.484,2852	23,437	180°31'28"	351°35'47"	17,3560	0,1266
27	MF	7.772.735,2785	375.484,0031	23,443	181°25'06"	352°29'25"	17,8140	0,1329
28	MF	7.772.734,5584	375.483,8851	23,455	181°43'40"	352°47'59"	18,5370	0,1449
29	BL	7.772.736,1575	375.484,1520	23,418	180°59'17"	352°03'36"	16,9320	0,1080
30	BL	7.772.735,5732	375.483,5616	23,442	182°53'04"	353°57'23"	17,5360	0,1321
31	BL	7.772.735,3829	375.483,8227	23,446	182°00'36"	353°04'55"	17,7150	0,1360
32	ASSOR	7.772.735,7630	375.483,8866	23,420	181°50'34"	352°54'53"	17,3330	0,1099

Nome	Descrição	Norte	Este	Cota
L1	E	7.772.736,4729	375.470,8229	23,385

Nome	Descrição	Norte	Este	Cota	Azimute	AH	DH	Desnível
L2	A	7.772.745,5575	375.419,8278	17,932	280°06'04"	240°45'16"	51,7980	-5,4529
33	ARVORE	7.772.736,5311	375.459,6831	22,890	270°17'58"	230°57'10"	11,1400	-0,4942
34	MURO	7.772.734,3497	375.459,6234	22,974	259°15'55"	219°55'07"	11,3990	-0,4105

Nome	Descrição	Norte	Este	Cota
L2	E	7.772.745,5575	375.419,8278	17,932

Nome	Descrição	Norte	Este	Cota	Azimute	AH	DH	Desnível
35	PE	7.772.736,9963	375.425,3267	19,854	147°17'13"	47°11'09"	10,1750	1,9228

Nome	Descrição	Norte	Este	Cota
L2	E	7.772.745,5575	375.419,8278	17,932

Nome	Descrição	Norte	Este	Cota	Azimute	AH	DH	Desnível
36	PE	7.772.737,4283	375.416,4682	17,903	202°27'16"	102°21'12"	8,7960	-0,0285
37	PE	7.772.738,2446	375.407,1785	15,323	239°58'01"	139°51'57"	14,6110	-2,6085
38	PE	7.772.738,4578	375.399,0482	12,677	251°08'12"	151°02'08"	21,9590	-5,2546
39	BL	7.772.745,8179	375.399,2294	11,884	270°43'28"	170°37'24"	20,6000	-6,0477
40	BL	7.772.745,8931	375.398,3484	11,618	270°53'43"	170°47'39"	21,4820	-6,3137
41	BL	7.772.746,1419	375.398,3858	11,642	271°33'41"	171°27'37"	21,4500	-6,2895
42	F	7.772.745,9925	375.398,8133	10,617	271°11'10"	171°05'06"	21,0190	-7,3145
43	ASSOR	7.772.739,6225	375.399,3963	12,323	253°48'09"	153°42'05"	21,2760	-5,6087
44	CR	7.772.737,6586	375.400,0465	15,206	248°13'58"	148°07'54"	21,3000	-2,7259
45	CR	7.772.737,3765	375.412,5991	18,046	221°27'50"	121°21'46"	10,9170	0,1140

Nome	Descrição	Norte	Este	Cota
B1	E	7.772.698,3563	375.474,9328	23,937

Nome	Descrição	Norte	Este	Cota	Azimute	AH	DH	Desnível
M0	A	7.772.664,7266	375.484,3340	24,098	164°22'54"	154°31'23"	34,9190	0,1613
C1	A	7.772.677,7590	375.471,8012	24,149	188°38'42"	178°47'11"	20,8340	0,2124
B1A	A	7.772.708,3481	375.442,7272	24,082	287°14'12"	277°22'41"	33,7200	0,1451
B2	A	7.772.700,5229	375.435,9039	24,042	273°10'39"	263°19'08"	39,0890	0,1056
46	GRADE	7.772.675,2176	375.472,8865	24,107	185°03'14"	175°11'43"	23,2290	0,1706
47	GRADE	7.772.673,7504	375.471,1898	24,148	188°38'58"	178°47'27"	24,8890	0,2111
48	MURO	7.772.688,0971	375.485,1145	24,093	135°13'02"	125°21'31"	14,4540	0,1558
49	CX-ESG	7.772.700,6142	375.474,7667	23,946	355°47'39"	345°56'08"	2,2640	0,0097
50	CX-ESG	7.772.700,4669	375.474,7961	23,948	356°17'46"	346°26'15"	2,1150	0,0110
51	CX-ESG	7.772.700,4450	375.474,6202	23,948	351°29'23"	341°37'52"	2,1120	0,0110
52	EDIF	7.772.696,8295	375.468,8020	24,103	256°00'56"	246°09'25"	6,3180	0,1660
53	EDIF	7.772.678,7831	375.468,0742	24,121	199°18'39"	189°27'08"	20,7400	0,1844
54	CX-ENE	7.772.679,8166	375.470,1969	24,125	194°19'47"	184°28'16"	19,1350	0,1878
55	CX-ENE	7.772.680,3378	375.470,0628	24,120	195°07'28"	185°15'57"	18,6650	0,1837
56	CX-ENE	7.772.680,3480	375.469,6969	24,121	196°12'42"	186°21'11"	18,7540	0,1841
57	CX-ENE	7.772.690,8044	375.470,5351	24,116	210°12'49"	200°21'18"	8,7390	0,1791
58	CX-ENE	7.772.691,3604	375.470,4572	24,100	212°36'31"	202°45'00"	8,3050	0,1637
59	CX-ENE	7.772.691,3001	375.470,0428	24,105	214°43'19"	204°51'48"	8,5850	0,1680
60	CX-ENE	7.772.698,2048	375.470,1302	24,095	268°11'35"	258°20'04"	4,8050	0,1580
61	CX-ENE	7.772.698,2149	375.470,6141	24,082	268°07'29"	258°15'58"	4,3210	0,1456
62	CX-ENE	7.772.698,6968	375.470,6413	24,096	274°32'13"	264°40'42"	4,3050	0,1590
63	CX-ENE	7.772.703,4994	375.467,0718	24,079	303°11'43"	293°20'12"	9,3940	0,1427
64	CX-ENE	7.772.703,8375	375.467,4606	24,078	306°15'43"	296°24'12"	9,2670	0,1409
65	CX-ENE	7.772.704,1981	375.467,1980	24,083	307°03'45"	297°12'14"	9,6930	0,1464
66	CX-ESG	7.772.699,1888	375.459,1367	24,074	273°01'01"	263°09'30"	15,8180	0,1372
67	CX-ESG	7.772.699,1210	375.459,9803	24,070	272°55'40"	263°04'09"	14,9720	0,1331
68	CX-ESG	7.772.698,4039	375.459,9658	24,083	270°10'57"	260°19'26"	14,9670	0,1464
69	CX-ESG	7.772.699,1768	375.458,5213	24,090	272°51'44"	263°00'13"	16,4320	0,1535
70	CX-ESG	7.772.698,4141	375.458,4249	24,109	270°12'02"	260°20'31"	16,5080	0,1718
71	CX-ESG	7.772.698,4074	375.457,6288	24,112	270°10'09"	260°18'38"	17,3040	0,1748
72	CX-ESG	7.772.699,2197	375.456,9435	24,099	272°44'52"	262°53'21"	18,0100	0,1618
73	CX-ESG	7.772.698,5671	375.456,9580	24,104	270°40'19"	260°48'48"	17,9760	0,1676
74	CX-ESG	7.772.698,4669	375.456,0971	24,098	270°20'12"	260°28'41"	18,8360	0,1609

Nome	Descrição	Norte	Este	Cota
B1	E	7.772.698,3563	375.474,9328	23,937

Nome	Descrição	Norte	Este	Cota	Azimute	AH	DH	Desnível
75	CX-ESG	7.772.698,6326	375.455,5437	24,107	270°49'00"	260°57'29"	19,3910	0,1707
76	CX-ESG	7.772.699,2912	375.455,5293	24,102	272°45'31"	262°54'00"	19,4260	0,1653
77	CX-ESG	7.772.699,3309	375.454,7082	24,108	272°45'32"	262°54'01"	20,2480	0,1709
78	LUM	7.772.699,4655	375.457,1373	24,090	273°34'00"	263°42'29"	17,8300	0,1529
79	LUM	7.772.704,2615	375.466,8861	24,089	306°16'27"	296°24'56"	9,9810	0,1524
80	CX-LAC	7.772.698,3642	375.463,0698	24,092	270°02'17"	260°10'46"	11,8630	0,1555
81	CX-LAC	7.772.698,3753	375.463,5068	24,107	270°05'43"	260°14'12"	11,4260	0,1698
82	CX-LAC	7.772.698,0065	375.463,4841	24,109	268°15'01"	258°23'30"	11,4540	0,1723
83	CX-LAC	7.772.698,2951	375.466,1930	24,101	269°35'56"	259°44'25"	8,7400	0,1639
84	CX-LAC	7.772.698,2122	375.466,5100	24,096	269°01'12"	259°09'41"	8,4240	0,1595
85	CX-LAC	7.772.697,9024	375.466,5130	24,096	266°54'51"	257°03'20"	8,4320	0,1591
86	CX-DREN	7.772.693,2962	375.469,0508	24,106	229°17'44"	219°26'13"	7,7590	0,1695
87	CX-DREN	7.772.692,8557	375.469,0182	24,117	227°04'37"	217°13'06"	8,0770	0,1801
88	CX-DREN	7.772.692,8999	375.468,6545	24,121	229°00'22"	219°08'51"	8,3180	0,1844
89	CX-DREN	7.772.683,9124	375.468,3386	24,111	204°32'19"	194°40'48"	15,8780	0,1737
90	CX-DREN	7.772.684,2925	375.468,4167	24,105	204°51'34"	195°00'03"	15,5000	0,1686
91	CX-DREN	7.772.684,2819	375.468,6920	24,114	203°54'47"	194°03'16"	15,3960	0,1775
92	CX-DREN	7.772.680,1074	375.468,5801	24,111	199°11'38"	189°20'07"	19,3230	0,1738
93	CX-DREN	7.772.680,4103	375.468,6018	24,119	199°25'55"	189°34'24"	19,0300	0,1822
94	CX-DREN	7.772.680,4620	375.468,2028	24,126	200°36'40"	190°45'09"	19,1180	0,1887
95	LUM	7.772.680,1141	375.470,4960	24,139	193°40'11"	183°48'40"	18,7740	0,2020
96	LUM	7.772.691,0880	375.470,8612	24,114	209°15'26"	199°23'55"	8,3310	0,1777
97	CX-LAC	7.772.687,5401	375.469,4576	24,117	206°50'56"	196°59'25"	12,1230	0,1803
98	CX-LAC	7.772.687,9392	375.469,5165	24,112	207°28'19"	197°36'48"	11,7410	0,1753
99	CX-LAC	7.772.687,9156	375.469,9054	24,133	205°42'42"	195°51'11"	11,5880	0,1959
100	BANCO-MESA	7.772.685,9839	375.470,2611	24,132	200°41'10"	190°49'39"	13,2250	0,1948
101	BANCO-MESA	7.772.685,6035	375.469,8726	24,137	201°38'34"	191°47'03"	13,7200	0,1998
102	BANCO-MESA	7.772.687,3156	375.469,8656	24,132	204°39'11"	194°47'40"	12,1480	0,1955
103	BANCO-MESA	7.772.687,3115	375.471,5886	24,146	196°50'44"	186°59'13"	11,5400	0,2092
104	BANCO-MESA	7.772.692,6855	375.471,8032	24,140	208°53'35"	199°02'04"	6,4770	0,2037
105	BANCO-MESA	7.772.694,6539	375.471,9763	24,133	218°36'30"	208°44'59"	4,7380	0,1960
106	BANCO-MESA	7.772.694,7179	375.469,9671	24,100	233°46'10"	223°54'39"	6,1560	0,1633
107	PAV-BLOQ	7.772.702,0541	375.459,6312	24,117	283°35'09"	273°43'38"	15,7420	0,1801
108	MF	7.772.706,9877	375.473,2496	24,003	348°57'57"	339°06'26"	8,7940	0,0662
109	PORTAO	7.772.706,9618	375.473,2685	24,006	349°03'16"	339°11'45"	8,7650	0,0688
110	PORTAO	7.772.704,2075	375.473,2120	24,015	343°36'44"	333°45'13"	6,0990	0,0779
111	QUADRA	7.772.712,9336	375.471,5134	24,108	346°47'57"	336°56'26"	14,9730	0,1711
112	TELHADO	7.772.707,7168	375.471,6604	24,093	340°43'50"	330°52'19"	9,9160	0,1558
113	ARQ	7.772.709,1080	375.469,0580	24,104	331°20'51"	321°29'20"	12,2520	0,1671
114	ARQ	7.772.711,8839	375.469,1876	24,091	336°59'21"	327°07'50"	14,6970	0,1547
115	ARQ	7.772.709,9762	375.443,1567	24,087	290°05'12"	280°13'41"	33,8340	0,1503
116	ARQ	7.772.712,7139	375.443,2864	24,060	294°24'12"	284°32'41"	34,7510	0,1229
117	TEL	7.772.709,4129	375.441,2080	24,086	288°09'06"	278°17'35"	35,4910	0,1494
118	CX-LAC	7.772.708,8729	375.442,5349	24,083	287°59'02"	278°07'31"	34,0620	0,1462
119	CX-LAC	7.772.708,8680	375.442,7963	24,083	288°06'46"	278°15'15"	33,8120	0,1458
120	CX-LAC	7.772.709,1343	375.442,8034	24,083	288°32'40"	278°41'09"	33,8890	0,1460
121	CX-LAC	7.772.708,2212	375.445,8335	24,084	288°43'38"	278°52'07"	30,7260	0,1477
122	CX-LAC	7.772.708,1668	375.446,3115	24,082	288°55'13"	279°03'42"	30,2560	0,1451

Nome	Descrição	Norte	Este	Cota
B1	E	7.772.698,3563	375.474,9328	23,937

Nome	Descrição	Norte	Este	Cota	Azimute	AH	DH	Desnível
123	CX-LAC	7.772.708,6633	375.446,3281	24,083	289°48'56"	279°57'25"	30,4050	0,1461
124	MF	7.772.708,1214	375.439,6969	24,032	285°29'24"	275°37'53"	36,5640	0,0953
125	CANALETA	7.772.708,0691	375.439,4615	24,037	285°18'49"	275°27'18"	36,7770	0,1005
126	GRELHA	7.772.705,0433	375.439,3934	24,036	280°39'22"	270°47'51"	36,1630	0,0993
127	GRELHA	7.772.708,0570	375.439,5484	24,037	285°19'52"	275°28'21"	36,6900	0,1005
128	GRELHA	7.772.708,1146	375.439,4211	24,038	285°21'55"	275°30'24"	36,8280	0,1008
129	GRELHA	7.772.705,2179	375.439,2729	24,026	280°53'30"	271°01'59"	36,3140	0,0897
130	ESCADA	7.772.706,7421	375.438,9695	24,076	283°07'32"	273°16'01"	36,9280	0,1393
131	ESCADA	7.772.708,5475	375.439,0915	24,088	285°52'22"	276°00'51"	37,2620	0,1515
132	RAMPA	7.772.702,3101	375.449,0935	24,091	278°41'59"	268°50'28"	26,1400	0,1541
133	RAMPA	7.772.704,3263	375.449,1694	24,080	283°02'48"	273°11'17"	26,4460	0,1431
134	SOLEIRA	7.772.697,5141	375.447,3646	24,277	268°15'01"	258°23'30"	27,5810	0,3406
135	RAMPA	7.772.704,7656	375.433,9438	25,594	278°53'14"	269°01'43"	41,4870	1,6575
136	MF	7.772.690,4667	375.475,8174	24,047	173°36'10"	163°44'39"	7,9390	0,1104
137	MF	7.772.692,3244	375.482,8962	23,958	127°08'31"	117°17'00"	9,9900	0,0210
402	PVA	7.772.677,2622	375.480,3957	24,044	165°28'51"	1°02'38"	21,7900	0,1072
403	PVA	7.772.699,5258	375.479,6325	23,959	76°01'35"	271°35'22"	4,8430	0,0223
404	BL	7.772.699,4307	375.482,6079	23,922	82°01'52"	277°35'39"	7,7500	-0,0150
405	BL	7.772.700,3435	375.482,6831	23,905	75°37'08"	271°10'55"	8,0010	-0,0316
406	BL	7.772.700,2898	375.483,0589	23,896	76°36'59"	272°10'46"	8,3530	-0,0407
407	ASSOR	7.772.700,2847	375.483,0365	23,896	76°36'53"	272°10'40"	8,3300	-0,0407
408	ASSOR	7.772.699,6017	375.476,1148	23,884	43°30'14"	239°04'01"	1,7170	-0,0531
409	BL	7.772.699,2658	375.476,0103	23,899	49°50'00"	245°23'47"	1,4100	-0,0378
410	BL	7.772.700,0253	375.475,9999	23,896	32°35'34"	228°09'21"	1,9810	-0,0410
411	BL	7.772.699,9493	375.476,3692	23,859	42°02'32"	237°36'19"	2,1450	-0,0782
412	PAP-AGUA	7.772.702,8022	375.472,7473	24,031	333°49'20"	169°23'07"	4,9540	0,0940

Nome	Descrição	Norte	Este	Cota
B1A	E	7.772.708,3481	375.442,7272	24,082

Nome	Descrição	Norte	Este	Cota	Azimute	AH	DH	Desnível
B1B	A	7.772.729,5955	375.438,0594	24,195	347°36'35"	240°22'23"	21,7540	0,1131
138	ESCADA	7.772.706,8078	375.437,3224	23,073	254°05'33"	146°51'21"	5,6200	-1,0087
139	ESCADA	7.772.708,6551	375.437,3099	23,041	273°14'35"	166°00'23"	5,4260	-1,0410
140	ESCADA	7.772.706,9887	375.435,5386	23,030	259°17'30"	152°03'18"	7,3160	-1,0522
141	ESCADA	7.772.708,7626	375.435,5000	23,018	273°16'57"	166°02'45"	7,2390	-1,0643
142	ESCADA	7.772.708,8690	375.434,0388	22,016	273°25'51"	166°11'39"	8,7040	-2,0663
143	ESCADA	7.772.707,0129	375.434,0007	22,010	261°18'02"	154°03'50"	8,8280	-2,0717
144	MURO	7.772.704,8086	375.438,9904	24,048	226°33'11"	119°18'59"	5,1470	-0,0341
145	MURO	7.772.706,6117	375.439,0627	24,052	244°38'45"	137°24'33"	4,0550	-0,0300
146	MURO	7.772.706,9810	375.434,0543	22,039	261°02'31"	153°48'19"	8,7800	-2,0432
147	MURO	7.772.708,8542	375.434,0719	22,020	273°20'46"	166°06'34"	8,6700	-2,0621
148	TN	7.772.704,4757	375.448,0507	24,108	126°02'00"	18°47'48"	6,5830	0,0263
149	MF	7.772.707,5867	375.455,4404	24,106	93°25'39"	346°11'27"	12,7360	0,0244
150	CX-LAC	7.772.708,3568	375.454,2482	24,083	89°57'26"	342°43'14"	11,5210	0,0014
151	CX-LAC	7.772.707,9289	375.453,7642	24,097	92°10'32"	344°56'20"	11,0450	0,0152
152	CX-LAC	7.772.707,9467	375.454,3062	24,098	91°59'09"	344°44'57"	11,5860	0,0160
153	CX-LAC	7.772.708,2373	375.445,8222	24,094	92°03'07"	344°48'55"	3,0970	0,0124

Nome	Descrição	Norte	Este	Cota
B1A	E	7.772.708,3481	375.442,7272	24,082

Nome	Descrição	Norte	Este	Cota	Azimute	AH	DH	Desnível
154	CX-LAC	7.772.708,6975	375.445,8738	24,088	83°39'56"	336°25'44"	3,1660	0,0062
155	CX-LAC	7.772.708,6529	375.446,3885	24,084	85°14'28"	338°00'16"	3,6740	0,0024
156	QUADRA	7.772.713,9588	375.441,1541	24,086	344°20'17"	237°06'05"	5,8270	0,0039
157	N	7.772.723,4569	375.444,4084	24,147	6°20'58"	259°06'46"	15,2020	0,0654
158	BASE	7.772.711,7623	375.440,8051	24,302	330°37'18"	223°23'06"	3,9180	0,2203
159	BASE	7.772.711,6606	375.438,0762	24,302	305°27'31"	198°13'19"	5,7100	0,2201
160	BASE	7.772.709,0466	375.438,1299	24,347	278°38'20"	171°24'08"	4,6500	0,2652
161	BASE	7.772.709,0498	375.440,7946	24,331	289°57'13"	182°43'01"	2,0560	0,2492
162	BASE-PE	7.772.708,9876	375.440,8914	24,090	289°12'19"	181°58'07"	1,9440	0,0082
163	BASE-PE	7.772.711,7670	375.440,8611	24,083	331°22'24"	224°08'12"	3,8950	0,0008
164	BASE-PE	7.772.711,7215	375.438,0275	23,660	305°40'15"	198°26'03"	5,7850	-0,4215
165	BASE-PE	7.772.708,9344	375.438,0578	23,444	277°09'24"	169°55'12"	4,7060	-0,6377
166	BASE-PE	7.772.708,9774	375.439,0070	23,791	279°36'01"	172°21'49"	3,7730	-0,2911
167	BASE-PE	7.772.708,9346	375.439,0537	24,082	279°04'16"	171°50'04"	3,7200	0,0000
168	PASSEIO	7.772.718,3909	375.439,2613	24,022	340°57'35"	233°43'23"	10,6240	-0,0595
169	QUADRA	7.772.731,4059	375.472,0008	24,006	51°46'26"	304°32'14"	37,2640	-0,0758
170	MURO	7.772.733,0512	375.473,6109	24,003	51°20'41"	304°06'29"	39,5480	-0,0787
171	MURO	7.772.731,9034	375.474,0119	24,002	53°01'22"	305°47'10"	39,1610	-0,0801
172	MURO	7.772.733,5817	375.472,1088	23,989	49°20'36"	302°06'24"	38,7300	-0,0928
173	CX-LAC	7.772.732,4293	375.464,7130	23,958	42°23'45"	295°09'33"	32,6080	-0,1239
174	CX-LAC	7.772.732,7894	375.464,8044	23,948	42°05'27"	294°51'15"	32,9360	-0,1337
175	CX-LAC	7.772.732,7040	375.465,2859	23,956	42°48'23"	295°34'11"	33,1980	-0,1263
176	MURO	7.772.734,0700	375.458,7893	23,945	31°58'59"	284°44'47"	30,3250	-0,1373
177	CX-LAC	7.772.733,1172	375.455,2815	23,929	26°52'43"	279°38'31"	27,7690	-0,1528
178	CX-LAC	7.772.732,6828	375.455,2330	23,938	27°11'57"	279°57'45"	27,3600	-0,1439
179	CX-LAC	7.772.732,6982	375.454,7106	23,943	26°12'12"	278°58'00"	27,1390	-0,1388
180	TN	7.772.706,5539	375.436,7235	23,453	253°21'38"	146°07'26"	6,2660	-0,6292
181	TN	7.772.704,9212	375.436,6659	23,442	240°31'01"	133°16'49"	6,9630	-0,6402
182	TN	7.772.706,7275	375.434,6287	22,320	258°41'01"	151°26'49"	8,2590	-1,7618
183	CANALETA	7.772.706,6430	375.434,1388	22,419	258°46'14"	151°32'02"	8,7560	-1,6627
184	CANALETA	7.772.706,7048	375.434,4844	22,251	258°43'30"	151°29'18"	8,4050	-1,8308
185	CANALETA	7.772.706,6012	375.434,3105	22,008	258°16'28"	151°02'16"	8,5960	-2,0739

Nome	Descrição	Norte	Este	Cota
B1B	E	7.772.729,5955	375.438,0594	24,195

Nome	Descrição	Norte	Este	Cota	Azimute	AH	DH	Desnível
186	EDIF	7.772.703,0578	375.432,0345	22,052	192°47'28"	25°10'53"	27,2130	-2,1428
187	CANALETA	7.772.709,1415	375.434,3533	22,026	190°16'13"	22°39'38"	20,7870	-2,1691
188	CANALETA	7.772.709,1523	375.434,8344	22,214	188°57'53"	21°21'18"	20,6960	-1,9809
189	SOLEIRA	7.772.719,7373	375.432,6641	22,087	208°41'29"	41°04'54"	11,2380	-2,1084
190	EDIF	7.772.727,1968	375.433,0589	21,817	244°22'24"	76°45'49"	5,5460	-2,3776
191	CANALETA	7.772.727,5891	375.435,5026	22,156	231°52'40"	64°16'05"	3,2500	-2,0393
192	CANALETA	7.772.727,1138	375.435,0794	21,904	230°12'51"	62°36'16"	3,8780	-2,2913
193	CANALETA	7.772.727,2239	375.435,2115	21,826	230°12'52"	62°36'17"	3,7060	-2,3693
194	TN	7.772.719,1052	375.435,5682	22,351	193°21'32"	25°44'57"	10,7820	-1,8443
195	PASSEIO	7.772.726,7417	375.434,9019	22,058	227°53'33"	60°16'58"	4,2560	-2,1365
196	PASSEIO	7.772.716,3819	375.434,3921	22,063	195°30'42"	27°54'07"	13,7130	-2,1316

Nome	Descrição	Norte	Este	Cota
B1B	E	7.772.729,5955	375.438,0594	24,195

Nome	Descrição	Norte	Este	Cota	Azimute	AH	DH	Desnível
197	PASSEIO	7.772.711,8229	375.439,0821	24,046	176°42'24"	9°05'49"	17,8020	-0,1490
198	TN	7.772.711,8275	375.439,0399	23,914	176°50'29"	9°13'54"	17,7950	-0,2806
199	PASSEIO	7.772.720,3064	375.439,3107	24,029	172°19'41"	4°43'06"	9,3730	-0,1662
200	PASSEIO	7.772.728,8839	375.439,6604	23,953	113°57'44"	306°21'09"	1,7520	-0,2424
201	LUM	7.772.726,6927	375.439,2060	23,924	158°26'44"	350°50'09"	3,1210	-0,2713
202	PASSEIO	7.772.731,9727	375.439,7567	23,917	35°31'30"	227°54'55"	2,9210	-0,2780
203	PASSEIO	7.772.734,7681	375.440,0234	23,884	20°47'30"	213°10'55"	5,5330	-0,3107
204	MURO	7.772.734,7653	375.440,0224	23,884	20°47'30"	213°10'55"	5,5300	-0,3105
205	MURO	7.772.734,7755	375.439,8041	23,040	18°36'51"	211°00'16"	5,4660	-1,1554
206	PE	7.772.734,7744	375.439,8167	23,039	18°44'36"	211°08'01"	5,4690	-1,1561
207	PE	7.772.732,0001	375.439,6964	23,293	34°14'45"	226°38'10"	2,9090	-0,9018
208	PE	7.772.732,1912	375.437,0868	22,707	339°27'33"	171°50'58"	2,7720	-1,4880
209	PE	7.772.729,0503	375.436,9456	22,864	243°55'10"	76°18'35"	1,2400	-1,3308
210	PE	7.772.728,9125	375.439,5625	23,719	114°26'06"	306°49'31"	1,6510	-0,4758
211	BASE	7.772.728,9749	375.439,9680	24,213	108°00'38"	300°24'03"	2,0070	0,0181
212	BASE	7.772.729,1337	375.436,9833	24,191	246°46'40"	79°10'05"	1,1710	-0,0041
213	BASE	7.772.732,1675	375.437,1501	24,194	340°31'50"	172°55'15"	2,7280	-0,0006
214	BASE	7.772.731,8991	375.440,0963	24,208	41°29'02"	233°52'27"	3,0750	0,0128
215	CX-LAC	7.772.732,9555	375.447,3313	23,955	70°04'49"	262°28'14"	9,8620	-0,2396
216	CX-LAC	7.772.733,5277	375.447,3266	23,952	67°00'28"	259°23'53"	10,0670	-0,2427
217	CX-LAC	7.772.733,5422	375.446,7678	23,946	65°37'10"	258°00'35"	9,5610	-0,2486
218	QUADRA	7.772.731,7604	375.441,7573	23,996	59°39'13"	252°02'38"	4,2850	-0,1988
219	CANALETA	7.772.732,9889	375.439,7517	23,373	26°30'21"	218°53'46"	3,7920	-0,8223
220	CANALETA	7.772.732,3822	375.439,7082	23,487	30°36'40"	223°00'05"	3,2380	-0,7078
221	CANALETA	7.772.732,7889	375.439,6641	23,266	26°40'48"	219°04'13"	3,5740	-0,9289
222	CANALETA	7.772.734,2577	375.437,8990	22,359	358°01'46"	190°25'11"	4,6650	-1,8361
223	CANALETA	7.772.734,5238	375.438,1856	22,366	1°28'01"	193°51'26"	4,9300	-1,8287
224	CANALETA	7.772.734,3168	375.438,1397	22,268	0°58'27"	193°21'52"	4,7220	-1,9270
225	MURO	7.772.734,9472	375.433,2969	21,965	318°20'05"	150°43'30"	7,1640	-2,2300
226	MURO	7.772.735,1622	375.425,2824	20,735	293°32'31"	125°55'56"	13,9370	-3,4595
227	MURO	7.772.727,8344	375.424,9390	20,990	262°21'20"	94°44'45"	13,2380	-3,2045
228	EDIF-030CM	7.772.727,8339	375.424,9361	20,991	262°21'18"	94°44'43"	13,2410	-3,2043
229	LUM	7.772.731,3010	375.429,4222	21,699	281°10'14"	113°33'39"	8,8040	-2,4960
230	POST-VAZIO	7.772.728,6731	375.431,9001	22,235	261°28'59"	93°52'24"	6,2280	-1,9596
231	CANALETA	7.772.727,6479	375.433,0818	21,892	248°37'52"	81°01'17"	5,3450	-2,3025
232	CANALETA	7.772.727,2163	375.432,9910	21,799	244°51'14"	77°14'39"	5,5990	-2,3955
233	TN	7.772.727,3743	375.429,9096	21,619	254°45'17"	87°08'42"	8,4470	-2,5760
234	EDIF	7.772.727,5024	375.426,5786	21,072	259°40'04"	92°03'29"	11,6700	-3,1228

Nome	Descrição	Norte	Este	Cota
B2	E	7.772.700,5229	375.435,9039	24,042

Nome	Descrição	Norte	Este	Cota	Azimute	AH	DH	Desnível
B3	A	7.772.699,5746	375.419,1056	22,260	266°46'08"	173°35'29"	16,8250	-1,7821
235	RAMPA	7.772.697,7549	375.446,3648	24,274	104°49'16"	11°38'37"	10,8210	0,2316
236	RAMPA	7.772.697,5396	375.449,7379	24,290	102°10'10"	8°59'31"	14,1520	0,2477
237	RAMPA	7.772.699,6726	375.449,8560	24,108	93°29'16"	0°18'37"	13,9780	0,0660
238	RAMPA	7.772.699,5926	375.446,3355	24,081	95°05'47"	1°55'08"	10,4730	0,0387

Nome	Descrição	Norte	Este	Cota
B2	E	7.772.700,5229	375.435,9039	24,042

Nome	Descrição	Norte	Este	Cota	Azimute	AH	DH	Desnível
239	CX-ESG	7.772.699,3512	375.441,6180	24,064	101°35'18"	8°24'39"	5,8330	0,0220
240	CX-ESG	7.772.699,3645	375.441,2590	24,077	102°12'22"	9°01'43"	5,4790	0,0349
241	CX-ESG	7.772.699,0129	375.441,2216	24,077	105°51'09"	12°40'30"	5,5280	0,0351
242	TN	7.772.697,0873	375.459,7193	24,081	98°12'32"	5°01'53"	24,0620	0,0389
243	CX-ENE	7.772.700,3581	375.444,4093	24,070	91°06'38"	357°55'59"	8,5070	0,0274
244	CX-ENE	7.772.700,3781	375.444,1506	24,068	91°00'22"	357°49'43"	8,2480	0,0254
245	CX-ENE	7.772.700,6240	375.444,1372	24,067	89°17'47"	356°07'08"	8,2340	0,0251
246	TN	7.772.702,6701	375.437,7505	24,075	40°41'48"	307°31'09"	2,8320	0,0329
247	TN	7.772.702,8292	375.436,5608	23,387	15°54'02"	282°43'23"	2,3980	-0,6556
248	CANALETA	7.772.702,9261	375.434,5445	22,301	330°30'19"	237°19'40"	2,7610	-1,7416
249	CANALETA	7.772.703,0067	375.434,0322	22,145	323°00'02"	229°49'23"	3,1100	-1,8971
250	CANALETA	7.772.703,0983	375.434,1622	22,047	325°55'46"	232°45'07"	3,1090	-1,9954
251	PASSEIO	7.772.702,9325	375.433,6403	22,006	316°47'23"	223°36'44"	3,3060	-2,0367
252	RAMPA	7.772.703,0107	375.433,9896	25,638	322°25'21"	229°14'42"	3,1390	1,5959
253	RAMPA	7.772.700,1642	375.435,0817	23,978	246°25'39"	153°15'00"	0,8970	-0,0642
254	RAMPA	7.772.702,6138	375.435,2101	24,006	341°38'37"	248°27'58"	2,2030	-0,0363
255	CS-GAS	7.772.698,0238	375.435,1408	23,994	196°58'45"	103°48'06"	2,6130	-0,0479
256	CS-GAS	7.772.699,4354	375.435,0675	24,008	217°33'45"	124°23'06"	1,3720	-0,0340
257	TN	7.772.699,5131	375.434,7934	23,703	227°43'00"	134°32'21"	1,5010	-0,3393
258	TN	7.772.700,0456	375.434,9006	23,707	244°33'27"	151°22'48"	1,1110	-0,3350
259	CS-GAS	7.772.699,5849	375.430,9489	23,474	259°16'49"	166°06'10"	5,0430	-0,5689
260	CS-GAS	7.772.698,2446	375.430,8529	23,260	245°43'18"	152°32'39"	5,5410	-0,7828
261	CX-ESG	7.772.698,2827	375.429,2056	23,182	251°30'27"	158°19'48"	7,0630	-0,8599
262	CX-ESG	7.772.699,4582	375.429,2181	23,028	260°57'05"	167°46'26"	6,7700	-1,0148
263	CX-ESG	7.772.699,5949	375.427,1962	22,737	263°55'00"	170°44'21"	8,7570	-1,3055
264	CX-ESG	7.772.698,4552	375.427,1888	22,440	256°39'11"	163°28'32"	8,9570	-1,6020
265	CX-ESG	7.772.700,5091	375.427,0939	22,756	269°54'37"	176°43'58"	8,8100	-1,2861
266	CX-ESG	7.772.699,6265	375.427,0320	22,751	264°13'49"	171°03'10"	8,9170	-1,2911
267	CX-ESG	7.772.699,5606	375.427,2331	22,786	263°40'01"	170°29'22"	8,7240	-1,2566
268	CX-ESG	7.772.699,5682	375.426,2208	22,631	264°22'08"	171°11'29"	9,7300	-1,4110
269	CX-LAC	7.772.702,1401	375.426,1044	22,551	279°22'16"	186°11'37"	9,9320	-1,4911
270	CX-LAC	7.772.702,1514	375.426,4105	22,582	279°44'02"	186°33'23"	9,6320	-1,4605
271	CX-LAC	7.772.702,5594	375.426,4794	22,589	282°11'36"	189°00'57"	9,6420	-1,4533
272	CX-LAC	7.772.702,0432	375.429,4526	23,084	283°15'37"	190°04'58"	6,6280	-0,9580
273	CX-LAC	7.772.702,0087	375.429,8073	23,141	283°41'48"	190°31'09"	6,2750	-0,9009
274	CX-LAC	7.772.702,3998	375.429,8114	23,133	287°07'22"	193°56'43"	6,3750	-0,9098
275	CX-LAC	7.772.702,1696	375.431,5680	23,393	290°47'46"	197°37'07"	4,6380	-0,6493
276	CX-LAC	7.772.702,1334	375.432,4344	23,535	294°54'01"	201°43'22"	3,8250	-0,5078
277	CX-LAC	7.772.702,4935	375.432,4367	23,526	299°36'43"	206°26'04"	3,9880	-0,5162
278	LUM	7.772.700,4868	375.429,8080	23,181	269°39'39"	176°29'00"	6,0960	-0,8610

Nome	Descrição	Norte	Este	Cota
B3	E	7.772.699,5746	375.419,1056	22,260

Nome	Descrição	Norte	Este	Cota	Azimute	AH	DH	Desnível
B4	A	7.772.692,1794	375.405,9473	21,694	240°39'48"	153°53'40"	15,0940	-0,5664
279	EDIF	7.772.698,5664	375.423,5620	22,280	102°44'53"	15°58'45"	4,5690	0,0197
280	EDIF-RAMPA	7.772.703,0747	375.423,6638	22,130	52°28'49"	325°42'41"	5,7470	-0,1301

Nome	Descrição	Norte	Este	Cota
B3	E	7.772.699,5746	375.419,1056	22,260

Nome	Descrição	Norte	Este	Cota	Azimute	AH	DH	Desnível
281	CX-AGUA	7.772.691,5376	375.422,2660	22,729	158°32'02"	71°45'54"	8,6360	0,4683
282	CX-AGUA-BA	7.772.684,0639	375.421,8583	22,548	169°56'12"	83°10'04"	15,7530	0,2872
283	CX-AGUA-BA	7.772.684,0913	375.419,3364	22,598	179°08'46"	92°22'38"	15,4850	0,3372
284	EDIF	7.772.680,5761	375.422,8295	23,062	168°54'36"	82°08'28"	19,3600	0,8015
285	PASSEIO	7.772.680,7395	375.421,8221	22,984	171°47'36"	85°01'28"	19,0300	0,7239
286	CX-LAC	7.772.683,6322	375.422,8274	22,944	166°51'35"	80°05'27"	16,3710	0,6832
287	CX-LAC	7.772.683,6974	375.422,2880	22,940	168°39'58"	81°53'50"	16,1930	0,6800
288	CX-LAC	7.772.683,3583	375.422,2006	22,962	169°11'41"	82°25'33"	16,5090	0,7013
289	CX-LAC	7.772.685,6588	375.422,2835	22,887	167°08'11"	80°22'03"	14,2740	0,6264
290	CX-LAC	7.772.686,5698	375.422,2521	22,823	166°23'55"	79°37'47"	13,3800	0,5623
291	CX-LAC	7.772.686,5554	375.422,9714	22,824	163°27'45"	76°41'37"	13,5810	0,5640
292	CX-LAC	7.772.689,7700	375.422,5350	22,695	160°43'17"	73°57'09"	10,3870	0,4349
293	CX-LAC	7.772.689,7270	375.422,5484	22,766	160°43'49"	73°57'41"	10,4320	0,5056
294	CX-LAC	7.772.689,3174	375.422,5437	22,778	161°28'11"	74°42'03"	10,8180	0,5175
295	CX-LAC	7.772.689,3092	375.422,8996	22,774	159°42'59"	72°56'51"	10,9440	0,5133
296	CX-LAC	7.772.691,5176	375.422,5134	22,741	157°04'26"	70°18'18"	8,7480	0,4810
297	CX-LAC	7.772.692,3109	375.422,5384	22,678	154°42'18"	67°56'10"	8,0340	0,4179
298	CX-LAC	7.772.692,2039	375.423,2216	22,693	150°49'12"	64°03'04"	8,4420	0,4329
299	CS-BOMBA	7.772.691,5802	375.421,0902	22,441	166°03'31"	79°17'23"	8,2370	0,1807
300	CS-BOMBA	7.772.691,6263	375.419,5902	22,379	176°30'40"	89°44'32"	7,9630	0,1185
301	CS-BOMBA	7.772.690,5710	375.419,5176	22,591	177°22'49"	90°36'41"	9,0130	0,3303
302	LUM	7.772.684,0373	375.408,1611	22,015	215°09'40"	128°23'32"	19,0050	-0,2458
303	ARVORE	7.772.681,9085	375.398,5420	21,799	229°20'04"	142°33'56"	27,1100	-0,4618
304	ARVORE	7.772.679,9414	375.396,3891	21,812	229°09'51"	142°23'43"	30,0250	-0,4481
305	ARVORE	7.772.682,1283	375.396,6150	21,752	232°11'56"	145°25'48"	28,4640	-0,5079
306	ARVORE	7.772.684,7291	375.397,2727	21,639	235°47'10"	149°01'02"	26,4020	-0,6213
307	MURO	7.772.689,5770	375.395,4516	20,879	247°05'18"	160°19'10"	25,6800	-1,3818
308	ARVORE	7.772.691,8014	375.404,8456	21,638	241°24'19"	154°38'11"	16,2410	-0,6225
309	ARVORE	7.772.695,3486	375.407,3639	21,469	250°12'21"	163°26'13"	12,4790	-0,7911
310	ARVORE	7.772.693,7433	375.404,5029	21,408	248°13'55"	161°27'47"	15,7240	-0,8523
311	LUM	7.772.699,3344	375.409,5126	21,762	268°33'57"	181°47'49"	9,5960	-0,4979
312	TN	7.772.687,2131	375.413,8303	22,168	203°06'38"	116°20'30"	13,4400	-0,0923
313	TN	7.772.696,0029	375.416,9554	22,091	211°02'56"	124°16'48"	4,1690	-0,1697
314	PASSEIO	7.772.698,6090	375.422,4333	22,245	106°10'53"	19°24'45"	3,4650	-0,0158
315	CX-ESG	7.772.700,4373	375.416,5672	22,025	288°46'13"	202°00'05"	2,6810	-0,2350
316	CX-ESG	7.772.700,3808	375.415,8036	22,027	283°43'13"	196°57'05"	3,3990	-0,2334
317	CX-ESG	7.772.699,6077	375.416,6958	22,150	270°47'17"	184°01'09"	2,4100	-0,1099

Nome	Descrição	Norte	Este	Cota
B4	E	7.772.692,1794	375.405,9473	21,694

Nome	Descrição	Norte	Este	Cota	Azimute	AH	DH	Desnível
318	MURO	7.772.680,5260	375.422,7716	23,099	124°42'31"	64°02'43"	20,4660	1,4052
319	MURO	7.772.675,7989	375.422,6312	22,975	134°28'28"	73°48'40"	23,3810	1,2809
320	MURO	7.772.704,2993	375.395,9376	18,818	320°26'50"	259°47'02"	15,7190	-2,8755
321	MURO	7.772.704,2060	375.397,7794	18,814	325°49'03"	265°09'15"	14,5380	-2,8798
322	ARVORE	7.772.708,2105	375.403,4400	19,547	351°06'39"	290°26'51"	16,2260	-2,1468
323	LUM	7.772.713,0971	375.410,4317	19,885	12°06'00"	311°26'12"	21,3930	-1,8094

Nome	Descrição	Norte	Este	Cota
B4	E	7.772.692,1794	375.405,9473	21,694

Nome	Descrição	Norte	Este	Cota	Azimute	AH	DH	Desnível
324	LUM	7.772.727,4776	375.411,7315	18,685	9°18'22"	308°38'34"	35,7690	-3,0092
325	MURO	7.772.735,6074	375.412,6293	18,116	8°44'50"	308°05'02"	43,9390	-3,5783
326	MURO	7.772.735,1996	375.424,9595	20,188	23°50'33"	323°10'45"	47,0340	-1,5056
327	MURO-ED	7.772.727,5273	375.424,7571	20,473	28°01'08"	327°21'20"	40,0410	-1,2209
328	ARVORE	7.772.732,4317	375.415,4728	19,232	13°18'50"	312°39'02"	41,3640	-2,4623
329	MURO	7.772.736,0645	375.399,8260	15,523	352°03'34"	291°23'46"	44,3100	-6,1707
330	TN	7.772.714,2365	375.424,1278	21,110	39°29'49"	338°50'01"	28,5840	-0,5843

Nome	Descrição	Norte	Este	Cota
T1	E	7.772.677,4590	375.449,3820	22,886

Nome	Descrição	Norte	Este	Cota	Azimute	AH	DH	Desnível
331	LUM	7.772.676,7502	375.461,8158	23,093	93°15'45"	4°01'45"	12,4540	0,2071
332	CX-ENE	7.772.676,6969	375.456,4883	22,996	96°07'15"	6°53'15"	7,1470	0,1103
333	CX-ENE	7.772.677,0696	375.456,4693	22,995	93°08'41"	3°54'41"	7,0980	0,1094
334	CX-ENE	7.772.677,0602	375.456,8203	22,989	93°04'07"	3°50'07"	7,4490	0,1034
335	CX-LAC	7.772.677,9497	375.456,9521	22,978	86°17'28"	357°03'28"	7,5860	0,0918
336	CX-LAC	7.772.678,3056	375.456,9246	22,950	83°35'44"	354°21'44"	7,5900	0,0643
337	CX-LAC	7.772.678,3285	375.456,5182	22,967	83°03'10"	353°49'10"	7,1890	0,0811
338	CX-LAC	7.772.678,5202	375.453,9247	22,912	76°51'03"	347°37'03"	4,6650	0,0256
339	CX-LAC	7.772.678,5000	375.453,5108	22,912	75°50'57"	346°36'57"	4,2580	0,0260
340	CX-LAC	7.772.678,1745	375.453,5155	22,915	80°10'49"	350°56'49"	4,1950	0,0287
341	RAMPA	7.772.674,9527	375.449,1015	22,871	186°23'12"	97°09'12"	2,5220	-0,0146
342	RAMPA	7.772.676,3234	375.449,1607	22,880	191°01'42"	101°47'42"	1,1570	-0,0064
343	RAMPA	7.772.676,2400	375.451,1663	23,046	124°20'25"	35°06'25"	2,1610	0,1595
344	TN	7.772.676,2958	375.451,1352	22,900	123°33'47"	34°19'47"	2,1040	0,0139
345	TN	7.772.677,9545	375.451,2007	22,901	74°45'30"	345°31'30"	1,8850	0,0153
346	RAMPA	7.772.677,9585	375.451,2152	23,199	74°45'30"	345°31'30"	1,9000	0,3131
347	RAMPA	7.772.674,7537	375.451,1794	23,052	146°23'59"	57°09'59"	3,2480	0,1660
348	RAMPA	7.772.674,7194	375.452,7028	23,036	129°31'22"	40°17'22"	4,3050	0,1496
349	RAMPA	7.772.676,1803	375.452,7975	23,064	110°31'28"	21°17'28"	3,6470	0,1781
350	RAMPA	7.772.677,8766	375.452,8741	23,178	83°10'48"	353°56'48"	3,5170	0,2924
351	RAMPA	7.772.679,4240	375.452,8374	23,188	60°22'28"	331°08'28"	3,9750	0,3025
352	TN	7.772.679,3391	375.453,0502	22,963	62°51'47"	333°37'47"	4,1220	0,0773
353	TN	7.772.674,7127	375.452,8962	22,990	128°00'25"	38°46'25"	4,4600	0,1039
354	RAM	7.772.679,5541	375.451,2978	23,200	42°26'23"	313°12'23"	2,8390	0,3139
355	RAM	7.772.679,6022	375.449,0234	23,375	350°30'03"	261°16'03"	2,1730	0,4889
356	RAMP	7.772.679,7671	375.445,5645	23,374	301°09'29"	211°55'29"	4,4610	0,4881
357	TN	7.772.679,7975	375.445,2878	22,949	299°43'59"	210°29'59"	4,7150	0,0628
358	ESCADA	7.772.677,5321	375.445,2556	22,921	271°00'53"	181°46'53"	4,1270	0,0350
359	ESCADA-RAM	7.772.678,1760	375.445,3178	23,374	280°00'19"	190°46'19"	4,1270	0,4883
360	ESCADA-RAM	7.772.677,9909	375.448,9680	23,361	322°06'21"	232°52'21"	0,6740	0,4747
361	ESCADA-RAM	7.772.677,3748	375.448,8385	22,893	261°11'50"	171°57'50"	0,5500	0,0073
362	TN	7.772.677,9869	375.448,9808	22,892	322°45'54"	233°31'54"	0,6630	0,0058
363	POSTE-TRAN	7.772.676,5062	375.434,2981	22,702	266°23'08"	177°09'08"	15,1140	-0,1844
364	EDIF	7.772.677,6880	375.436,5370	22,741	271°01'17"	181°47'17"	12,8470	-0,1446
365	EDIF	7.772.676,6670	375.436,5113	22,739	266°28'44"	177°14'44"	12,8950	-0,1465
366	EDIF	7.772.676,8129	375.431,9119	22,562	267°52'55"	178°38'55"	17,4820	-0,3236

Nome	Descrição	Norte	Este	Cota
T1	E	7.772.677,4590	375.449,3820	22,886

Nome	Descrição	Norte	Este	Cota	Azimute	AH	DH	Desnível
367	LUM	7.772.678,1060	375.431,1425	22,547	272°01'54"	182°47'54"	18,2510	-0,3395
368	LUM	7.772.677,6735	375.441,3529	22,866	271°31'48"	182°17'48"	8,0320	-0,0200
369	CX-ENE	7.772.678,2628	375.443,5441	22,921	277°50'24"	188°36'24"	5,8930	0,0347
370	CX-ENE	7.772.678,2413	375.444,2705	22,927	278°42'05"	189°28'05"	5,1710	0,0408
371	CX-ENE	7.772.678,9333	375.444,3547	22,937	286°20'40"	197°06'40"	5,2390	0,0514
372	CX-ENE	7.772.679,1066	375.440,8455	22,793	280°55'27"	191°41'27"	8,6940	-0,0931
373	CX-ENE	7.772.678,4964	375.440,8579	22,860	276°56'21"	187°42'21"	8,5870	-0,0261
374	CX-ENE	7.772.678,4443	375.440,2259	22,855	276°08'31"	186°54'31"	9,2090	-0,0307
375	CX-ENE	7.772.676,7504	375.440,8122	22,855	265°16'24"	176°02'24"	8,5990	-0,0308
376	CX-ENE	7.772.676,6992	375.441,4784	22,882	264°30'32"	175°16'32"	7,9400	-0,0038
377	CX-ENE	7.772.677,3807	375.441,5274	22,870	269°25'43"	180°11'43"	7,8550	-0,0165
378	CX-ENE	7.772.678,7114	375.437,3178	22,771	275°55'36"	186°41'36"	12,1290	-0,1149
379	CX-ENE	7.772.678,7037	375.437,9526	22,785	276°12'55"	186°58'55"	11,4970	-0,1012
380	CX-ENE	7.772.679,2040	375.437,9605	22,778	278°41'12"	189°27'12"	11,5540	-0,1076
381	CX-ENE	7.772.678,7367	375.433,0730	22,619	274°28'46"	185°14'46"	16,3590	-0,2667
382	CX-ENE	7.772.679,2629	375.433,0885	22,629	276°19'03"	187°05'03"	16,3930	-0,2573
383	CX-ENE	7.772.679,3041	375.432,4764	22,618	276°13'43"	186°59'43"	17,0060	-0,2676
384	CX-ENE	7.772.679,6811	375.428,0585	22,482	275°56'57"	186°42'57"	21,4390	-0,4041
385	CX-ENE	7.772.679,6730	375.428,6046	22,472	276°04'57"	186°50'57"	20,8950	-0,4142
386	CX-ENE	7.772.679,1149	375.428,4885	22,512	274°31'53"	185°17'53"	20,9590	-0,3738
387	TN	7.772.680,7742	375.423,1446	22,342	277°12'05"	187°58'05"	26,4460	-0,5442
388	CX-LAC	7.772.679,4777	375.433,5048	22,655	277°14'45"	188°00'45"	16,0050	-0,2314
389	CX-LAC	7.772.679,4149	375.434,1168	22,622	277°18'05"	188°04'05"	15,3900	-0,2640
390	CX-LAC	7.772.678,7687	375.434,1101	22,665	274°54'06"	185°40'06"	15,3280	-0,2212
391	TN	7.772.680,2761	375.436,7432	22,735	282°33'56"	193°19'56"	12,9490	-0,1508
392	CX-ENE	7.772.676,9590	375.437,2763	22,757	267°38'06"	178°24'06"	12,1160	-0,1293
393	CX-ENE	7.772.677,3534	375.437,3115	22,771	269°29'56"	180°15'56"	12,0710	-0,1147
394	CX-ENE	7.772.677,3354	375.436,8506	22,754	269°26'06"	180°12'06"	12,5320	-0,1317
395	CX-DRENO	7.772.678,7123	375.441,7208	22,877	279°17'28"	190°03'28"	7,7630	-0,0087
396	CX-DRENO	7.772.678,6746	375.442,0714	22,890	279°26'27"	190°12'27"	7,4110	0,0036
397	CX-DRENO	7.772.679,0877	375.442,0507	22,891	282°31'32"	193°17'32"	7,5100	0,0046
398	CX-LAC	7.772.679,0225	375.444,3514	22,954	287°15'53"	198°01'53"	5,2680	0,0675
399	CX-LAC	7.772.678,9383	375.445,2987	22,973	289°54'53"	200°40'53"	4,3430	0,0875
400	CX-LAC	7.772.679,7661	375.445,2551	22,943	299°12'24"	209°58'24"	4,7280	0,0565
401	PAV-BLOQ	7.772.677,1467	375.444,7235	22,914	266°09'53"	176°55'53"	4,6690	0,0283

Nome	Descrição	Norte	Este	Cota
M1	BASE-M1	7.772.753,0870	375.484,4440	23,310
2	TN	7.772.752,8760	375.484,5340	23,352
3	MF	7.772.755,6650	375.484,4420	23,262
4	MURO	7.772.755,5160	375.486,7610	23,288
5	MURO	7.772.745,7620	375.486,6180	23,468
6	MF	7.772.746,3480	375.484,2270	23,364
7	MF	7.772.745,4680	375.484,1230	23,379
8	MF	7.772.744,5900	375.484,5340	23,366
9	MF	7.772.743,9270	375.485,4140	23,395
10	MF	7.772.743,7480	375.486,1580	23,419
11	MF	7.772.743,4030	375.491,9330	23,353
12	MURO	7.772.745,5220	375.492,0830	23,428
13	MF	7.772.735,7930	375.492,9060	23,470
14	MF	7.772.735,9640	375.485,2850	23,497
15	MF	7.772.735,8300	375.484,3040	23,526
16	MF	7.772.735,1630	375.483,8640	23,573
17	BL	7.772.736,2550	375.484,1140	23,540
18	BL	7.772.735,6490	375.483,4620	23,592
19	BL	7.772.735,4380	375.483,6770	23,640
20	ASSOREADA	7.772.735,8120	375.483,9220	23,646
21	POSTE	7.772.734,9000	375.485,5300	23,887
22	PVA	7.772.739,5380	375.480,4780	23,593
23	MURO	7.772.734,7900	375.451,1580	22,485
24	MURO	7.772.735,6580	375.424,9280	20,165
25	PASSEIO	7.772.736,9360	375.425,0110	20,158
26	MF	7.772.738,3480	375.425,1870	19,304
27	MF	7.772.745,2610	375.425,4790	19,042
28	MURO	7.772.747,6490	375.425,5720	19,237
29	MF	7.772.745,7510	375.412,5510	16,011
30	MURO	7.772.748,1900	375.413,1550	17,144
31	MF	7.772.738,8600	375.414,0680	16,773
32	PASSEIO	7.772.737,1510	375.419,7660	19,321
33	MURO	7.772.735,8610	375.419,1670	19,258
34	MURO	7.772.736,0970	375.412,5370	18,218
35	PASSEIO	7.772.737,3960	375.412,4740	18,121
36	CR	7.772.737,4220	375.412,1910	17,938
37	CR	7.772.737,2260	375.407,9500	17,001
38	MURO	7.772.736,1080	375.407,9500	17,342
39	PASSEIO-PE	7.772.736,8010	375.420,4880	23,195
40	MF	7.772.738,8290	375.413,5890	16,616
41	MF	7.772.739,0640	375.408,5360	15,281
42	POSTE	7.772.747,1120	375.408,4470	15,563
43	MF	7.772.745,8660	375.408,6910	14,824
44	BL	7.772.745,8630	375.399,1730	11,979
45	BL	7.772.745,8790	375.398,3840	11,731
46	PVA	7.772.744,0370	375.398,0920	11,809
47	MURO	7.772.748,8830	375.396,9310	11,413
48	MF	7.772.746,8180	375.382,1900	9,808
49	MURO	7.772.749,5390	375.381,5350	9,925

Nome	Descrição	Norte	Este	Cota
50	MURO	7.772.737,2740	375.381,3020	10,691
51	MF	7.772.739,9320	375.381,5490	10,007
52	MF	7.772.739,5760	375.392,0860	10,730
53	MF	7.772.739,4150	375.397,7080	11,977
54	PE	7.772.737,0800	375.398,0650	12,452
55	PE	7.772.738,7990	375.398,2330	12,383
56	CR	7.772.737,6900	375.400,1450	15,009
57	MURO-DIVISA	7.772.736,3650	375.399,2910	14,817
58	BL	7.772.739,8400	375.399,8150	12,499
59	BL	7.772.739,8040	375.398,9720	12,269
60	BL	7.772.739,4120	375.398,9300	12,269
61	MF	7.772.653,9680	375.481,9380	24,137
62	MURO	7.772.654,1990	375.484,8350	24,362
63	MURO	7.772.658,9230	375.485,0670	24,309
64	MURO	7.772.660,5530	375.485,8820	24,295
65	MURO	7.772.661,2890	375.487,7280	24,229
66	MURO	7.772.661,3400	375.488,9420	24,253
67	MF	7.772.662,5530	375.482,2670	24,146
68	MF	7.772.663,8770	375.483,1640	24,121
69	MF	7.772.664,8790	375.484,5740	24,094
70	MF	7.772.665,1040	375.485,7790	24,091
71	MF	7.772.664,7830	375.493,5630	23,960
72	MURO	7.772.661,0620	375.493,9590	24,136
73	MURO	7.772.673,1910	375.495,1380	24,273
74	MF	7.772.671,7610	375.495,1280	23,945
75	MF	7.772.672,1450	375.486,9320	24,069
76	MF	7.772.672,5450	375.485,2220	24,121
77	MF	7.772.673,4550	375.484,0330	24,096
78	MF	7.772.675,0400	375.483,1420	24,070
79	MF	7.772.677,3330	375.482,5770	24,134
80	MURO	7.772.675,5580	375.484,8320	24,418
81	MURO	7.772.674,2250	375.485,4480	24,382
82	MURO	7.772.673,4640	375.487,2470	24,328
83	PVA	7.772.677,2610	375.480,3270	24,223
84	MF	7.772.676,6320	375.475,3740	24,092
85	MF	7.772.674,7910	375.475,2700	24,217
86	MF	7.772.673,3720	375.474,5710	24,072
87	MF	7.772.672,6100	375.473,6680	24,247
88	MF	7.772.672,2580	375.472,3940	24,115
89	MF	7.772.672,2810	375.471,2380	24,080
90	TELA	7.772.673,7370	375.471,3250	24,240
91	PVE	7.772.669,5980	375.476,8240	24,142
92	PVE	7.772.667,4920	375.472,4030	24,123
93	MF	7.772.663,4400	375.475,3060	24,165
94	MF	7.772.664,3350	375.474,8650	24,148
95	MF	7.772.665,1190	375.474,0830	24,150
96	MF	7.772.665,6960	375.472,6670	24,206
M0	M0	7.772.664,7340	375.484,2970	24,186
A1	A1	7.772.698,6490	375.475,8920	24,229

Nome	Descrição	Norte	Este	Cota
99	MURO-DIVISA	7.772.676,7040	375.394,7260	21,474
100	MF	7.772.674,8330	375.394,6780	21,311
101	POSTE	7.772.675,3240	375.395,4020	21,608
102	MURO	7.772.676,9080	375.386,5620	20,924
103	MF	7.772.668,2790	375.386,1270	20,704
104	MURO	7.772.666,0590	375.385,7100	21,004
105	MURO	7.772.665,9710	375.392,5360	21,673
106	MURO	7.772.665,8570	375.393,7220	21,752
107	MURO	7.772.666,6050	375.394,1990	21,908
108	MURO	7.772.666,2830	375.411,5250	22,671
109	MF	7.772.667,9180	375.411,4120	22,644
110	MF	7.772.674,5030	375.410,0070	22,487
111	PORTAO	7.772.676,0690	375.411,0730	22,795
112	PORTAO	7.772.675,9980	375.414,0520	22,785
113	PVE	7.772.669,3910	375.421,4270	23,098
114	MF	7.772.667,3930	375.426,4990	23,240
115	MURO	7.772.665,8140	375.426,7110	23,504
116	MURO	7.772.675,3060	375.428,2420	23,483
117	MF	7.772.673,8510	375.428,0170	23,287
118	POSTE	7.772.674,1960	375.432,6460	23,683
119	PORTAO	7.772.674,7470	375.445,5490	23,828
120	PORTAO	7.772.674,7080	375.448,2600	23,885
121	CX-TEL	7.772.674,0430	375.444,4840	23,803
122	CX-TEL	7.772.674,0150	375.443,8800	23,795
123	CX-TEL	7.772.674,3940	375.443,8910	23,804
124	MF	7.772.673,1900	375.445,9660	23,700
125	MF	7.772.666,7070	375.446,7640	23,766
126	MF	7.772.672,9280	375.455,6750	23,873
127	GRADE	7.772.674,4120	375.452,8800	23,956
128	MF	7.772.666,3470	375.456,7680	23,927
129	MURO	7.772.665,3700	375.456,8660	24,395
130	ESCADA	7.772.677,3450	375.448,9460	23,908
131	ESCADA	7.772.677,9930	375.448,9950	24,376
132	ESCADA	7.772.677,4530	375.445,2310	23,929
133	ESCADA	7.772.678,0730	375.445,2780	24,405
T1	T1	7.772.677,4590	375.449,3820	22,886
C1	A	7.772.677,7590	375.471,8012	24,149

Titulo:
Monografia BASE

Folha: 01/02

Data: 19/12/2019

Dados de Localização

Localidade: EEEFM Jacaraípe

Município: Serra

Estado: Espírito Santo

Coordenadas

DATUM SIRGAS 2000 FUSO 24 MC -39°

MODELO GEOIDAL: MAPGEO2015

UTM (Universal Transversa
de Mercator)

Geográficas

Norte: 7.772.753,087

Latitude(gms) -20°08'18,3837

Este: 352.049,197

Longitude(gms) -40°11'28,7407

**Cota: 23,31

**Altitude Ortométrica (m)

Descrição: Prego de aço, usado para levantamento topográfico do local citado.

Croqui de Localização



Itinerário: Localizado no meio fio próximo a esquina

*Coordenadas SIRGAS obtidas através da medição de vetores GPS referenciado ao SGB(Sistema Geodésico Brasileiro).

Confere com Geoprocessamento

Titulo:

Monografia BASE

Folha: 02/02

Data: 16/12/2019



Sumário do Processamento do marco: 1047766

Início: AAAA/MM/DD HH:MM:SS,SS	2019/10/24 12:11:06,00
Fim: AAAA/MM/DD HH:MM:SS,SS	2019/10/24 14:02:11,00
Modo de Operação do Usuário:	ESTÁTICO
Observação processada:	CÓDIGO & FASE
Modelo da Antena:	CHCI80 NONE
Órbitas dos satélites:¹	FINAL
Frequência processada:	L3
Intervalo do processamento(s):	1,00
Sigma² da pseudodistância(m):	5,000
Sigma da portadora(m):	0,010
Altura da Antena³(m):	1,710
Ângulo de Elevação(graus):	10,000
Resíduos da pseudodistância(m):	1,67 GPS 2,32 GLONASS
Resíduos da fase da portadora(cm):	0,98 GPS 0,99 GLONASS

Coordenadas SIRGAS

	Latitude(gms)	Longitude(gms)	Alt. Geo.(m)	UTM N(m)	UTM E(m)	MC
Em 2000.4 (É a que deve ser usada) ⁴	-20° 08' 18,3837"	-40° 11' 28,7407"	15,89	7772753.087	375484.444	-39
Na data do levantamento ⁵	-20° 08' 18,3760"	-40° 11' 28,7430"	15,89	7772753.323	375484.376	-39
Sigma(95%)⁶ (m)	0,002	0,004	0,006			
Modelo Geoidal	MAPGEO2015					
Ondulação Geoidal (m)	-7,42					
Altitude Ortométrica (m)	23,31					

Precisão esperada para um levantamento estático (metros)

Tipo de Receptor	Uma frequência		Duas frequências	
	Planimétrico	Altimétrico	Planimétrico	Altimétrico
Após 1 hora	0,700	0,600	0,040	0,040
Após 2 horas	0,330	0,330	0,017	0,018
Após 4 horas	0,170	0,220	0,009	0,010
Após 6 horas	0,120	0,180	0,005	0,008

¹ Órbitas obtidas do International GNSS Service (IGS) ou do Natural Resources of Canada (NRCAN).

² O termo "Sigma" é referente ao desvio-padrão.

³ Distância Vertical do Marco ao Plano de Referência da Antena (PRA).

⁴ A coordenada oficial na data de referência do Sistema SIRGAS, ou seja, 2000.4. A redução de velocidade foi feita na data do levantamento, utilizando o modelo VEMOS em 2000.4.

⁵ A data de levantamento considerada é a data de início da sessão.

⁶ Este desvio-padrão representa a confiabilidade interna do processamento e não a exatidão da coordenada.

Os resultados apresentados neste relatório dependem da qualidade dos dados enviados e do correto preenchimento das informações por parte do usuário. Em caso de dúvidas, críticas ou sugestões contate: ibge@ibge.gov.br ou pelo telefone 0800-7218181. Este serviço de posicionamento faz uso do aplicativo de processamento CSRS-PPP desenvolvido pelo Geodetic Survey Division of Natural Resources of Canada (NRCAN)

Processamento autorizado para uso do IBGE.

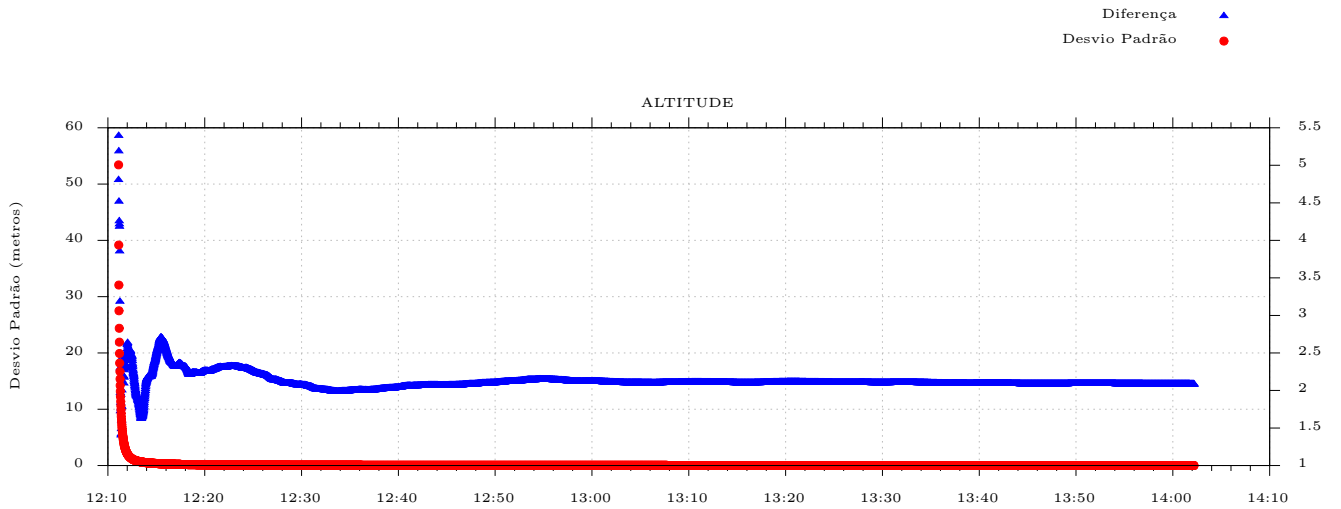
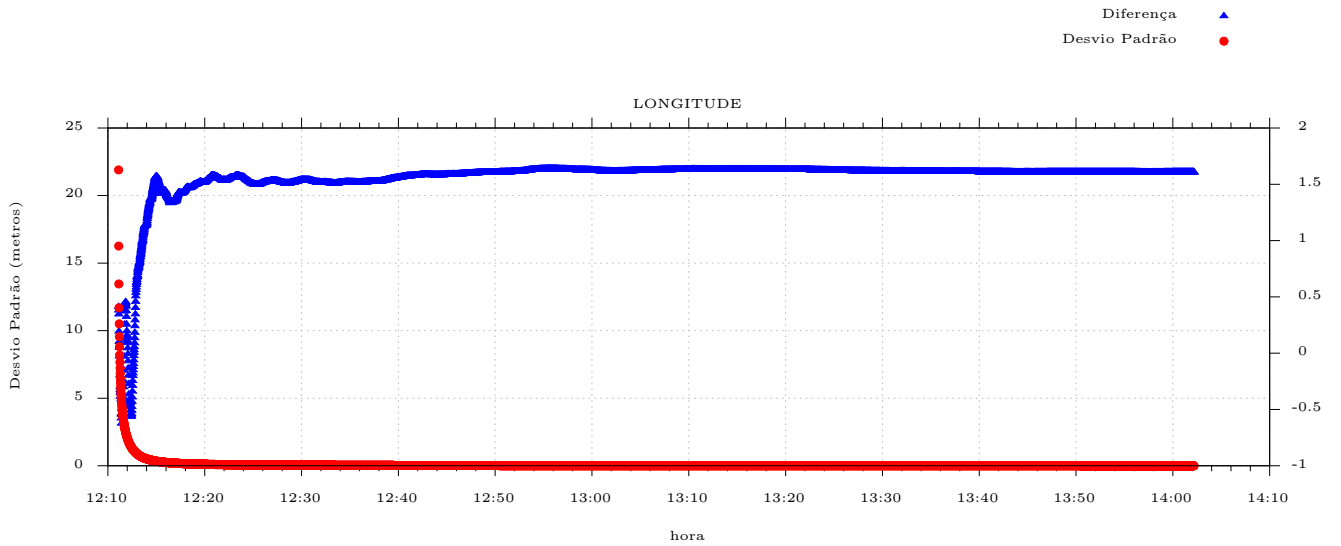
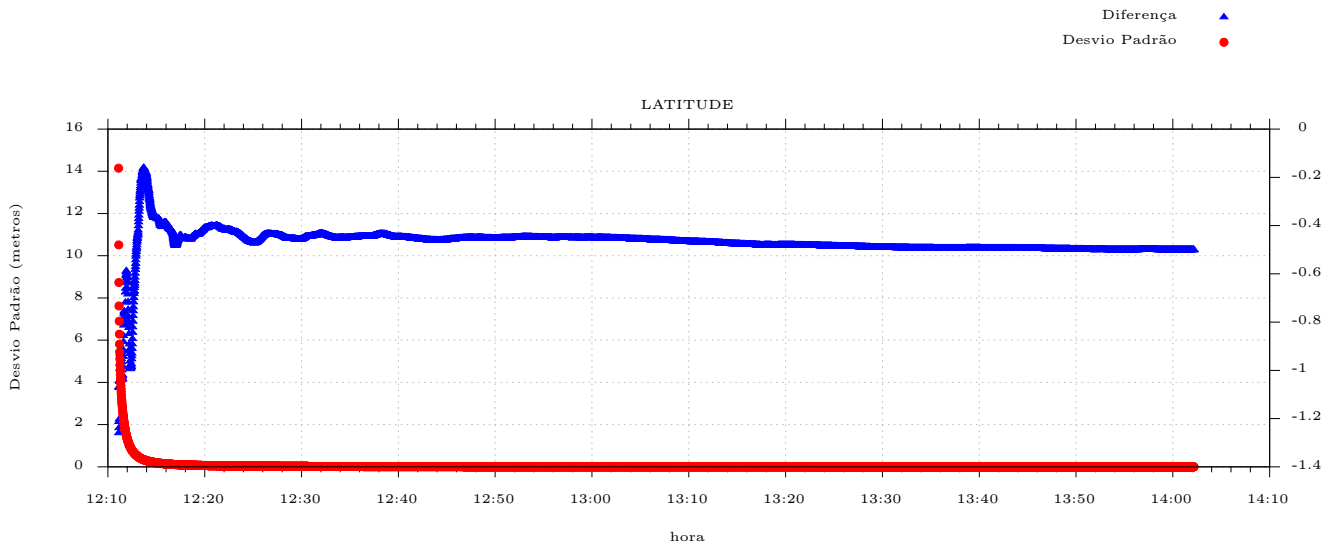

CAPTURADO POR	
ANDRÉIA SEGLIA TEC DE EDIFICACOES SEDU - GERFE	
DATA DA CAPTURA	01/04/2020 18:04:14 (HORÁRIO DE BRASÍLIA - UTC-3)
VALOR LEGAL	ORIGINAL
NATUREZA	DOCUMENTO NATO-DIGITAL

ASSINARAM O DOCUMENTO	
WILSON RODRIGUES GONÇALVES ARQUITETO COORD SR SEDU - GERFE Assinado em 01/04/2020 10:04:37 Documento original assinado eletronicamente, conforme art. 6, § 1º, do Decreto 4410-R/2019.	
MOISÉS BRITO SOBRINHO ENG COORD CIVIL SR SEDU - GERFE Assinado em 31/03/2020 18:05:08 Documento original assinado eletronicamente, conforme art. 6, § 1º, do Decreto 4410-R/2019.	
FELIPE DE BRITO AURÉLIO ENG COORD ELETRIC SR SEDU - GERFE Assinado em 01/04/2020 15:42:35 Documento original assinado eletronicamente, conforme art. 6, § 1º, do Decreto 4410-R/2019.	
EDSON DE OLIVEIRA PIRES ENG COORD GERAL MAST SEDU - GERFE Assinado em 01/04/2020 18:04:13 Documento original assinado eletronicamente, conforme art. 6, § 1º, do Decreto 4410-R/2019.	

A disponibilidade do documento pode ser conferida pelo link <https://e-docs.es.gov.br/documento/registro/2020-103HV5>



Consulta via leitor de QR Code.